

CITY OF ORANGE

INVESTIGATIVE SERVICES DIVISION · PHONE: (714) 744-7501 · FAX: (714) 744-7504 · www.cityoforange.org

August 19, 2021

Kelly Ribuffo
Associate Planner
Planning Department
300 E Chapman
Orange, CA 92867

Dear Ms. Ribuffo;

CUP: 3142-21
CHIPOTLE MEXICAN GRILL – 112 E Maple Avenue
“41” On-Sale Beer & Wine Eating Place

Figures supplied by the State Department of Alcohol Beverage Control (ABC) for the location in Census Tract #: 759.01 shows:

The number of ON-SALE licenses <u>allowed</u> are:	5
The number of ON-SALE licenses <u>existing</u> are:	24
The number of OFF-SALE licenses <u>allowed</u> are:	2
The number of OFF-SALE licenses <u>existing</u> are:	4

We show this location to be RD 023W, and our current figures show crimes at 94. The average number of reported crimes per district is 74 (crime stats from 2020). This is 20% above the average reported crime.

- **ON-SALE IS OVER CONCENTRATED**
- **OFF-SALE IS OVER CONCENTRATED**
- **HIGH CRIME AREA**

ABC code 23958.4 (a) defines over concentrated and high crime area: *a high crime area is defined as a 20% greater number of reported crimes, than the average number of reported crimes as determined from all crime reporting districts within the jurisdiction of the local law enforcement agency.*

Location checked in in-house: **Yes (attached)** City Planner: Kelly Ribuffo

Communication Log:

Date/Time email received : June 15, 2021

Evaluation:

Chipotle Mexican Grill will be located at 112 East Maple Avenue in the City of Orange. The site is located on the southwest corner of Maple Avenue and North Orange Street. The location is comprised of .08 acres which includes a 4,276 square foot building with two tenant space. Currently the Pie Hole is located next to the spaces. Chipotle's entry door would face East Maple Avenue.

Valerie Sacks is the Applicant's ABC liquor consultant. Chipotle is proposing indoor/outdoor seating and sale of beer and wine. Chipotle is requesting a Type 41 On-Sale Beer & Wine Eating Place license.

I sent Mrs. Sacks via email the Orange Police Department Conditions for their pending ABC License. Mrs. Sacks told me the Applicant understood the conditions and CUP questionnaire. Mrs. Sacks noted that conditions 18 and 29 relate to hostess/waitress service. Chipotle's business model does not have waitress/hostess service at any of their business locations. Conditions 18 and 29 would not apply to Chipotle's CUP.

Chipotle plans include an outdoor patio area. The patio will consist of four tables, with each table having four seats, for a total seating capacity of 16. The walkway seating on Maple Avenue will consist of six tables, with each table having two seats, for a total seating capacity of 12. The patio area will be designated by landscaping. Mrs. Sacks also stated Chipotle will not allow customers to consume alcohol in their outdoor seating/patio area. She stated if Chipotle were to allow customers to consume alcohol outside, they would have to abide by the conditions for #27 prior to service.

In addition, the applicant states the location will include a "Chipotlane" on Maple Avenue frontage which will be a walkup window accessible on foot only. There will be approximately twelve employees on premises during any given shift. The proposed hours of operation are 9:00 am until 11:00 pm, seven days a week. The applicant owns and operates more than 2,700 restaurants throughout the United States, Canada and overseas.

According to Chipotle's plans, the cooler, containing beer and wine, will be located in the north east portion of the facility. It will be behind the cash register/serving table, in a lockable container. Only the employee will have access to the cooler. The employee working the register/serving table will have a visual of all customers entering and exiting the location.

Concentration Levels:

The census tract figures supplied by ABC show 4 allowed with 24 existing on-sale (over-concentrated) and 2 allowed with 4 existing off-sale (over-concentrated) licenses. BP Code 23958.4 addresses concentration as the number of existing ABC licensed establishments within a given census tract, which is based upon population within each tract.

Crime Statistics and Activity:

The crime statistics for Reporting District 023W shows crimes at 94. The average number of reported crimes per reporting district is 74. Additionally, Reporting District 023W has the 26th highest reported crime rate out of 92 districts in the City of Orange, and is 26% above the average of all reporting districts. Of the 60 total arrests in this reporting district, 16 were alcohol related; 15 for DUI and one for disorderly conduct.

Census Tract / Sensitive Sites:

There are a number of businesses located within close proximity of the establishment. There are no sensitive land issues (i.e., schools) within 500 feet of the location.

Recommendation:

The Police Department does not oppose the applicant's efforts to obtain a Type 41 On-Sale General Eating Place license. Although this area is considered to be over-concentrated and over saturated, approving this application will not be an additional strain on Police resources and services.

Sincerely,

A handwritten signature in blue ink, appearing to read 'Dan Adams', is written over the 'Sincerely,' text.

Dan Adams
Chief of Police

ORANGE POLICE DEPARTMENT

CUP CONDITIONS

OPERATIONAL CONDITIONS:

1. ☒ In conjunction with the ongoing operation of the business, the premises shall comply with all requirements placed upon it by the State Alcoholic Beverage Control (ABC) Board.
2. ☒ This Conditional Use Permit (CUP) shall be reviewed one year from the date of approval and may be reviewed each year thereafter. The review shall be conducted jointly by the Community Development Director and Police Chief or designees. The purpose of this review shall be to identify uniquely adverse issues such as curfew, loitering, vandalism, criminal activity, noise, or nuisance resulting from approval of the CUP. If such issues are identified, the CUP shall be presented to the Planning Commission for their consideration of conditions, modifications or revocation.
3. ☒ The activity level of the business shall be monitored by the Police Department to establish the level of police services used for the business. Should the level of police services demonstrate that the applicant has not controlled excessive, or unnecessary activity resulting in high use of police services then this Conditional Use Permit shall be reviewed for consideration of further conditions, modifications or revocation.
4. ☒ The quarterly gross sales of alcoholic beverages shall not exceed the gross sales of food and meals during the same time period. The licensee shall at all times maintain records which reflect separately the gross sales of food and the gross sales of alcoholic beverages of the licensed business. Records shall be kept no less frequently than on a quarterly basis and shall be made available on request.
5. ☒ The use of the building is considered a restaurant. Interior construction will remain consistent with plans submitted for review by the Planning Commission. No changes to the floor plans will occur unless a permit is issued by the Community Development Department. None of the floor area will be designated for dancing or live entertainment unless a subsequent Conditional Use Permit is approved by the Planning Commission.
6. ☒ No person in the establishment shall appear in such a manner that the genitals, pubic hair, pubic hair region, buttocks, anus, natal cleft, anal region, nipple or areola is exposed to public view or is not covered by an opaque covering.
7. ☒ The subject alcoholic beverage license shall not be exchanged for a public premises type license nor operated as a public premise.

8. ☒ The sale of beer and/or wine for consumption off the premises shall be prohibited.
9. ☒ No alcoholic beverages shall be consumed on any property adjacent to the licensed premises under the control of the license.
10. ☒ All alcohol shall be consumed on the subject site. Signs shall be posted on all exits of the premises, which prohibit alcoholic beverages from leaving the confines of the premises.
11. ☒ The premises shall be maintained as a bona fide restaurant and shall provide a menu containing an assortment of foods normally offered in such restaurants.
12. ☒ The hours of operation shall be daily 9:00 am until 11:00 pm. These hours do not restrict employees from being on the premises before opening for preparations and deliveries or after close for clean-up. Clean-up may not be conducted by patrons.
13. ☒ At no time shall there be a fee for entrance/admittance into the premises.
14. ☒ Employees and/or contract security personnel shall not consume any alcoholic beverages prior to or during their work shift. Any and all security officers provided shall comply with all state and local ordinances regulating their services, including, without limitation, Chapter 11.5 of Division 3 of the California Business and Profession Code.
15. ☒ The applicant agrees to indemnify, hold harmless, and defend the City, its officers, agents, and employees from any and all liability or claims that may be brought against the City arising out of its approval of this permit, save and except that caused by City's active negligence.

ALCOHOL & FOOD SERVICE CONDITIONS:

16. ☒ At all times when the premises are open for business, the sale and service of alcoholic beverages shall be made only in conjunction with the sale of food.
17. ☒ Food service, with an available menu, shall be available until closing time on each day of operation.
18. ☐ Alcoholic beverages served shall be served by a waiter/waitress only, and only to seated patrons at permitted tables.
19. ☒ There shall be no bar or lounge area upon the licensed premises maintained for the sole purpose of the sale, service, or consumption of alcoholic beverages directly to patrons for consumption.

20. ☒ There shall be no "Happy Hours" when alcoholic beverages are offered at a reduced rate.
21. ☒ There should be no time when alcoholic beverages are sold at a ratio of two for one; no "stacking" of beverages, which means the serving of two alcoholic beverages at one time to the same customer; and no sales to an "empty chair", which means that each customer must be physically present at the time of the order of any alcoholic beverage.
22. ☒ There shall be no promotions encouraging intoxication or drinking contests.
23. ☒ There shall be no requirement to purchase a minimum number of drinks.
24. ☒ No alcoholic beverages shall be sold from any temporary locations on the premises such as ice tubs, barrels, or any other containers.
25. ☒ Alcoholic beverages shall be sold and served in containers, which are distinguishable from other non-alcoholic beverages sold at the premises.
26. ☒ The petitioner shall not employ or permit any persons to solicit or encourage others, directly or indirectly, to buy them drinks in the licensed premises under any commission percentage salary or other profit.

PATIO CONDITIONS:

27. ☒ The patio shall be enclosed and any gates located on the patio shall remain closed during business hours and used as an emergency exit only. Sign(s) shall be posted on all patio gate(s) indicating "Emergency Exit Only".
28. ☒ The petitioner shall not employ or permit any persons to solicit or encourage others, directly or indirectly, to buy them drinks in the licensed premises under any commission percentage salary or other profit.
29. ☐ Patrons on the patio shall be seated by a host/hostess only, with no self-seating permitted.
30. ☒ An employee shall visually monitor the patio at all times to monitor alcohol.

SPECIAL EVENTS:

31. ☒ No portion of the premises shall be deemed to be "private" for the purposes of dispensing alcoholic beverages to selected patrons, where the licensee recognizes

any form of membership cards, keys or passes which would entitle the holder entry or preferential admittance or exclusive use of any portion of the mentioned premises.

- 32. ☒ The use of a promoter (such as a night-club operator) or sub-leasing the premises to be used in conjunction with dancing and/or live entertainment is prohibited.
- 33. ☒ There shall be no live entertainment (including karaoke), disc jockey, amplified music, or dancing permitted on the premises at any time. Amplified music over a built-in system designed for background music shall be permitted so long as the music is not audible outside when doors are open.
- 34. ☒ There shall be no special promotional events held on the property, unless a written request for such is received and approved by the City of Orange Community Development Director and the Police Department's Vice Unit at least one week in advance of the event.

COIN OPERATED MACHINES:

- 35. ☒ There shall be no more than 4 coin-operated games maintained upon the premises at any time.
- 36. ☒ The business may utilize a token coin system to reduce the likelihood of theft and burglaries for U.S. currency in coin operated machines. Should the token system be implemented, the requirements for a burglary alarm system may be waived.
- 37. ☒ All coin change machines, dollar bill change machines, or token machines that accept and retain U.S. currency shall meet the following:
 - A) The machine is to be designed and constructed to be resistant to unauthorized forced entry attempts from any accessible side of the machine.
 - B) The machine is to be installed and secured to prevent its removal from the point of installation within the business.

SECURITY & EXTERIOR:

- 38. ☒ The parking lot of the premises shall be equipped with lighting of sufficient power to illuminate and make easily discernible the appearance and conduct of all persons on or about the parking lot. If there are any lighting issues the business with immediately notify property management.

39. ☒ Lighting in the parking area of the premises shall be directed, positioned and shielded in such a manner so as not to unreasonably illuminate the window area of nearby residences. If there are any lighting issues the business with immediately notify property management.
40. ☒ The owner shall install and maintain a closed circuit television system capable of readily identifying facial features, and stature of all patrons entering the establishment during hours of operation and monitoring the rear of the premises. The camera system shall keep a minimum 30 day library of events, which shall be available for downloading and inspection by the Orange Police Department.
41. ☒ The use of any amplifying systems, outdoor sound system and paging system or any other such device is prohibited on the licensed premises.
42. ☒ The petitioner(s) shall be responsible for maintaining free of litter the area adjacent to the premises over which he/she has control.
43. ☒ There shall be no exterior advertising of any kind or type, including advertising directed to the exterior from within, promoting or indicating the availability of alcoholic beverages. Interior displays of alcoholic beverages that are clearly visible to the exterior shall constitute a violation of this condition.
44. ☒ Exterior doors and windows, as well as the interior of the business, shall be protected by an approved alarm system, which shall detect an attempted entry or presence of people within the business during closing hours.
45. ☒ Uniformed security will be provided by the applicant on days/nights when special event broadcast(s) are being promoted. One security guard per 100 customers shall be present during these broadcasts/events.
46. ☒ Provide an interior night light to illuminate the interior, and maintain an unobstructed view through storefront windows to provide police patrol officers the ability to observe unlawful activity within the business.
47. ☒ The owner or manager of the licensed premises shall maintain on the premises a written security policy and procedures manual addressing at a minimum the following items: Handling obviously intoxicated persons; establishing a reasonable ratio of employees to patrons, based upon activity level, in order to monitor beverage sales and patron behavior; handling patrons involved in fighting or arguing; handling loitering about the building and in the immediate adjacent area that is owned, leased, rented or used under agreement by the Licensee(s); verifying age/checking identification of patrons; warning patrons of reaching their drinking limit/potential intoxication and refusing to serve; calling the police regarding observed or reported criminal activity.

48. ☒ The applicant shall comply with all federal, state, municipal laws and/or ordinances. Any violations of these laws in connection with this use may be a cause for revocation of this permit.

TRAINING:

49. ☒ All employees of petitioner who sell or serve alcoholic beverage products shall be required to complete a training program in alcoholic beverage compliance, crime prevention techniques and the handling of violence. For new employees of petitioner, such training program must be completed within 30 days of the date of hire. The employees must provide the City of Orange Police Department, Vice Unit, a copy of completed Alcohol Management Program (AMP) certificate.

MISCELLANEOUS:

50. ☐ The business shall prohibit the admission of, or allow any person under the age to 18 years to remain upon the premises after the hour of 10:00 PM, unless accompanied by an adult.
51. ☒ Graffiti shall be removed from the exterior walls and windows of the premises within 72 hours of discovery.
52. ☐ The business shall prohibit the admission of, or allow any person under the age of 18 years to remain upon the premise between the hours of 8:00 a.m. and 3:00 p.m. Monday and Friday, when Orange Unified School District (OUSD) has school in session, unless that person is accompanied by a parent or legal guardian. This condition shall apply to all school students, including those who attend schools other than those in OUSD.

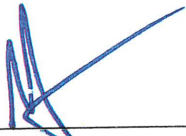

Dan Adams
Chief of Police



Chris Moten
Sergeant



Eric Rosauer
Captain, Investigative Services



Tanner McLeod
Investigator

PROJECT DESCRIPTION
REQUEST FOR Conditional Use Permit
City of Orange
Chipotle Mexican Grill Store #3983
112 E. Maple Avenue 92866

Chipotle Mexican Grill (Chipotle Mexican Grill, LLC, d/b/a Chipotle Mexican Grill, ("the Applicant" and/or "Chipotle") is seeking the following discretionary approval:

Pursuant to **Section 17.30.010 of the City of Orange Zoning Code (RSMZC)**, the Applicant requests a **Conditional Use Permit ("CUP")** to allow the sale and/or dispensing of beer and wine for on-site consumption in connection with its forthcoming 60-seat 2,610 s.f. restaurant with hours of operation and alcohol sales from 9 am to 11 pm daily, located on a .08-acre lot in the OTMU-15 zone.

PROJECT DESCRIPTION

The Applicant, Chipotle, is requesting conditional use approval to serve beer and wine pursuant to a type 41 ABC license for on-site consumption at its forthcoming location at 112 E. Maple Avenue in City of Orange ("Site"). Chipotle expects to open summer 2021. The restaurant will be 2,610 s.f. in size and provide 60 seats – 32 seats inside and 28 patio seats -- 16 on-site and 12 on the public right-of-way. The Applicant is not requesting the ability to serve alcohol on the patio.

This location will also include a "Chipotlane" on the Maple Avenue frontage, which will be a walkup window accessible on foot only. This will be adjacent to the 12 patio seats located along the sidewalk between the restaurant and Maple Avenue. In addition, there will be 16 patio seats adjacent to the parking lot. These seats will be buffered by a landscaped area. Patrons will not be able to consume alcohol in either outdoor area but inside the restaurant only.

The Applicant believes that its request for a Conditional Use Permit to serve beer and wine for on-site consumption along with meals at its "fast casual" Mexican-style restaurant is warranted based upon the company's outstanding record of compliance with the California Department of Alcoholic Beverages ("ABC"), the appropriateness of the location for the requested use, and its overall reputation as a well-established, responsible company which can be trusted to manage the requested ABC license appropriately.

THE APPLICANT

The Applicant owns and operates more than 2,700 restaurants throughout the United States, Canada, and overseas, and continues to expand its brand. The Applicant attributes its tremendous growth rate since it opened its first location in 1993 on its vision for its restaurants. The idea is simple: demonstrate that customers could be served good quality food in a distinctive atmosphere--quickly and at an affordable price point. Chipotle uses high-quality raw ingredients, classic cooking methods and distinctive interior design--features that are more frequently found in the world of fine dining. The Applicant essentially established the category of dining now called "fast-casual," the fastest growing segment of the restaurant industry, where customers expect food quality that's more in line with full-service restaurants, but with the simplified menus, speed, and convenience of fast food.

As the company has grown, the Applicant's vision has evolved as well. The Applicant incorporates a concern for the environmental and societal impact of its restaurants into its business model. Features of this model, which the Applicant calls "Food with Integrity," include a commitment to high-quality food, sustainable business practices, charitable giving, and responsible sourcing of animal products. This philosophy is part of an overall commitment to running a business which has a positive impact on its employees, its patrons, its environmentally minded vendors and suppliers, and the communities in which its restaurants are located. Chipotle promotes from within, so that oftentimes employees who start out as line cooks work their way up until they are managing multiple locations. Certainly, practices designed to ensure appropriate training and management practices related to sales of alcoholic beverage products are an important feature of Chipotle's corporate philosophy. Indeed, the Applicant has an outstanding record of compliance with the California ABC and parallel regulatory agencies wherever its restaurants are located.

THE SITE

The subject Site is located on the southwest corner of Maple Avenue and North Orange Street and is comprised of .08 acres. The Site is improved with a 4276 s.f. building comprised of two tenant spaces, including The Pie Hole and the forthcoming Chipotle space, which was most recently occupied by a café. Immediately adjacent to and to the south of the Site along Glassell Street are Woody's Antiques, a "cupcakery," Tokyo Café, and the Pizza Press. Across the street along Glassell, there is a Christian Center, a comic bookstore, and a variety of other restaurant, café, and retail uses. Across the street in a northerly direction, across Maple, are still more restaurants and similar uses, such as The Filling Station Café and Philz Coffee. The Chapman University alumni house is a block to the west along Maple Avenue.

The Site is located within the Historic Core of the City of Orange. Overall, this area can be described as a charming and walkable commercial hub that has a variety of small and/or locally owned establishments. Parking for Chipotle as well as other commercial uses in the vicinity is provided on City-owned surface parking lots, including one containing more than 100 spaces immediately adjacent to the Site. The Site falls under the Downtown Parking Exemption.

The Chipotle space is on the corner but is oriented toward Maple and is adjacent to the existing surface parking lot, which can be entered from Orange Street, the street parallel to Glassell Street and to the east of the Chipotle space. As noted above, Chipotle will be taking over a space formerly occupied by a restaurant/café. As such, there will be no intensification to the Site in terms of parking demand, traffic, or otherwise.

Furthermore, the location, size, design, and operating characteristics of the proposed Conditional Use Permit for the sale of beer and wine at Chipotle's forthcoming restaurant will not create unusual noise, traffic or other conditions or situations that may be objectionable, detrimental, or incompatible with other permitted uses in the vicinity. Chipotle will be located within an existing commercial hub where site access, parking, and other improvements have already been made, and will not be significantly modified as a result of the proposed use.

REQUEST/OPERATIONAL DETAILS

In terms of the request for the within Conditional Use Permit to enable service of beer and wine at its restaurant, Chipotle's experience at its over 2,700 locations worldwide is that its customers appreciate having

the ability to enjoy these items with their meals. The ability to offer these items is an important component of Chipotle's business model and is one of various features that help distinguish it from other casual dining venues. Particularly in light of the impact of Covid-19 on restaurants, the Applicant's ability to offer these items will be an important component ensuring its long-term viability at this location, as will the inclusion of patio dining.

Alcohol consumption will not be permitted on the patio, as certain types of barriers are required by the ABC, and no such barriers will be installed here. In terms of the façade design, signage, landscaping, patio design, and other physical features of the new restaurant, those are being separately reviewed through the City of Orange's Design Review process. Thus, the within request is operational only, and refers only to aspects of the restaurant that pertain to alcohol service.

The Applicant's hours of operation will be 9:00 a.m. – 11:00 p.m. daily. Chipotle requests coterminous hours of alcohol sales. The Applicant believes that the requested hours are modest, and that they are consistent with uses surrounding the Site. The total number of employees at this location will be 25 once it is open for inside dining, with approximately 12 employees on-premises during any given shift. Currently, because of Covid-19 restrictions which mean that all sales are either for take-out or patio dining, its restaurants are more lightly staffed. It is anticipated that such restrictions will no longer be necessary by the time this Chipotle location opens, anticipated to be Fall of 2021.

The Applicant anticipates alcohol sales to comprise only a very small percentage of gross sales at the restaurant. This has been borne out by its experience at other locations. Further, the Applicant recognizes an obligation to be a respectful operator within the community and welcomes input from the Community Development Department and the Orange Police Department. Ultimately, the reputation of the company depends in part on its ability to ensure that all of its locations operate in a manner which is not detrimental to the character of the development of the neighborhoods in which its restaurants are located. Chipotle has established procedures in place at its restaurants to ensure the responsible management of these products. Chipotle as a company is committed to providing a safe and enjoyable experience to its patrons and seeks to operate all of its restaurants in a manner which is consistent with this goal.

In addition, a corporate-managed restaurant such as Chipotle is less likely to have the kinds of problems occasionally associated with alcohol sales in environments that are undercapitalized and/or not professionally managed. Chipotle's staff is trained to recognize and appropriately deal with any problems related to alcoholic beverage sales if they were to arise. The Applicant sets very strict guidelines for the purchase and handling of these items to ensure that the problems sometimes associated with irresponsible management of these products never becomes an issue at any Chipotle location. Examples of such practices include the following:

- 1) Extensive staff training, including specifically alcohol awareness;
- 2) Beer caps are removed at the point of sale to ensure no off-site consumption;
- 3) Alcohol is not sold for off-site consumption with take-out food orders or otherwise at any location ordinarily (some aspects of operations may be modified on a temporary basis as a result of Covid-19);
- 4) Only employees 21 years of age or older open bottles or hand customers drinks, which is stricter than ABC requirements;
- 5) There is always at least one on-site manager over the age of 21 on the premises;

- 6) Chipotle does not offer happy hour;
- 7) Chipotle never serves beer or alcohol in "pitchers";
- 8) Beer is served in bottles, not cups;
- 9) Stores are designed so that employees working the food line or the register can easily see and visually monitor the customer floor area;
- 10) Employees who regularly circulate the store to clean up and bus tables are also tasked with the duty of monitoring customers to ensure that no alcoholic beverages are shared;
- 11) Only one alcoholic beverage per adult customer is served at any one time.

For all of the above reasons, the Applicant respectfully requests the City of Orange's approval of a Conditional Use Permit to enable the sale of beer and wine and outdoor dining, and submits that it is warranted.



ORANGE POLICE DEPARTMENT

INVESTIGATIVE SERVICES DIVISION

Please fill out and provide the following information reference your application for a modification / new license:

Business Name: Chipotle Mexican Grill

Business Location: 112 East Maple Avenue, Orange, CA 92866

Date: June 17, 2021

1. Names & Dob of all principals / owners:

Chipotle Mexican Grill, Inc. is a publicly traded entity.

2. Names of all managers:

Managers have not yet been assigned to this location.

3. Name of building owner:

James Housley, KMaple J, LLC

4. Length of lease:

10 years, with options to extend up to 25 years total.

5. Proposed days & hours of operations:

9 am – 11 pm daily

6. Are you planning on having any live entrainment?

No

7. Do you plan on using a DJ, live band or karaoke?

No

8. Do you plan on having any dancing?

No

9. Do you plan on having any coin operated games, if so how many?

No

10. Are you planning on having "happy hour" (drink or food offered at reduced prices or free)?

No

11. Do you plan on hosting any special events at this location, if so what type of events?

No

12. Do you plan on renting out or leasing this business to any third party or agents?

No

13. Are you planning on having any private or V.I.P. rooms?

No.

14. What other business that hold an ABC license are you involved with, if you are involved please provide all business names and addresses of these businesses.

Chipotle Mexican Grill owns and operates more than 2800 locations throughout the US, Canada, and overseas.

15. Do you plan on charging admission?

No.

16. Does the business have a patio area, if yes are you planning on serving any alcoholic beverage on this patio?

There are two patio areas, as depicted on the plans and described in the filing materials submitted with the Application. Because neither of the patio areas will have adequate barriers for purposes of alcoholic beverage consumption, alcoholic beverages will not be permitted in the patio areas.

17. List all businesses and their addresses you have been connected to in the last 5 years as well as co-owners and co-workers?

Please see attached spreadsheet for locations of other Chipotles in the state of California that have opened in the last 5 years. Chipotle Mexican Grill is a publicly traded company and all stores are company owned. It is obviously infeasible to list coworkers.

Name of person interviewed:

VALERIE SACKS

Investigator Assigned:



Investigator Tanner McLeod #1574

Store Number	Store Name	Grand Opening Proj.	Street Address
04-3372	Aliso Viejo	5/8/2019	26661 Aliso Creek Road
04-2975	Baldwin Park	2/22/2018	13916 Garvey Ave.
04-3041	Banning	10/5/2017	300 South Highland Springs Ave
04-2703	Berkeley Shattuck	12/7/2017	2225 Shattuck Avenue
04-3550	Bishop Ranch	3/10/2020	132 Sunset Dr.
04-3428	Bristol St	4/23/2020	260 Bristol St
04-3132	Brookhurst St	3/29/2018	17150 Brookhurst St
04-3104	Cabazon	10/10/2018	48557 Morongo Trail
04-3184	Cerritos College Square	6/17/2018	10826 Alondra Boulevard
04-3612	Chico North	7/28/2020	962 East Ave.
04-2985	Citadel Outlets	4/20/2017	150 Citadel Drive
04-3119	City West	1/18/2018	1122 West 6th Street
04-3179	Claremont Promenade	12/7/2017	885 S. Indian Hill Blvd.
04-2876	Clovis NE	2/9/2017	1840 Herndon Ave
04-3671	Coronado Island	8/12/2020	1360 Orange Ave
04-3588	Costa Mesa	6/23/2020	468 E 17th St.
04-2877	Crenshaw Imperial Plaza	7/27/2017	2944 West Imperial Hwy.
04-2941	Crown Valley	4/12/2018	27750 Crown Valley Parkway
04-3534	CSUN	6/26/2020	9160 Reseda Blvd
04-3162	Del Paso Marketplace	11/21/2018	2800 Del Paso Road, Suite 100
04-3148	Diamond Bar	1/18/2018	235 S Diamond Bar Blvd, Suite B
04-3472	DOCO	12/16/2019	615 David J Stern Walk
04-3168	Downtown Long Beach	3/8/2018	245 Pine Ave, Suite 190
04-1924	East Anaheim	6/8/2017	5631 East La Palma Ave
04-3062	Echo Park	2/1/2018	2134 W. Sunset Blvd.
04-3395	El Dorado Hills	4/13/2021	4520 Post Street
04-3288	ELK GROVE 2	11/7/2018	4730 Elk Grove Boulevard
04-3352	Eureka	4/9/2020	2626 Broadway Street
04-3537	Foothill Ranch Relo	10/23/2020	26592 Towne Centre Dr
04-3005	Fremont Warm Springs	3/16/2017	44029 Osgood Road
04-2974	Hacienda Valley	10/22/2019	15495 E Valley Blvd
04-2681	Harbor and Orangethorpe	3/30/2017	101 E Orangethorpe Ave
04-3277	Hollister	8/11/2020	1250 E Park Street
04-3578	Hollywood Park	5/26/2020	3421 W Century Blvd
04-2947	Imperial Beach	8/3/2017	801 Palm Ave
04-3504	Indio	12/7/2020	42213 Jackson St., Ste 106
04-3094	Ladera Heights	4/7/2018	6719 La Tijera Blvd
04-3535	Lathrop	12/8/2020	16542 Golden Valley Parkway
04-3586	Los Banos	4/13/2021	1420 E. Pacheco Blvd.
04-2892	Manchester Mall	6/1/2017	3520 N Blackstone Ave
04-2944	Mar Vista	5/4/2017	11711 National Blvd.
04-2945	Marina	1/19/2017	140 General Stillwell Drive
04-2711	Mission Hills	12/14/2017	10384 N. Sepulveda Blvd., Ste 2E
04-2501	Monterey & Dinah Shore	6/29/2017	34100 Monterey Ave
04-3640	Moorpark	6/16/2020	806 E Los Angeles Ave.
04-3035	Mt Vernon Bakersfield	11/2/2017	2630 Mt Vernon Avenue

04-3078	North County Mall	5/10/2017 200 E Via Rancho Pkwy
04-3026	North Hills	6/26/2018 8420 Balboa Blvd
04-3388	Oroville	11/20/2019 325 Oroville Dam Blvd
04-2738	Pacific Palisades	1/19/2017 15207 Sunset Blvd.
04-2893	Paramount	2/23/2017 15754 Paramount Blvd.
04-3577	PCC II	3/19/2020 1687 E Colorado Blvd
04-2955	Perris	6/1/2017 1870 N. Perris Blvd
04-3373	Placentia	9/11/2019 1474 North Kraemer Blvd
04-3338	Pleasanton	6/28/2019 6654 Koll Center Pkwy
04-3252	Porterville	7/31/2019 1174 W Henderson Ave
04-3506	Reynolds Ranch	11/6/2019 2601 Reynolds Ranch Pkwy
04-2424	Rialto	7/20/2017 1314 S Riverside Avenue
04-2998	Sacramento Delta Shores	12/14/2017 8124 Delta Shores Circle
04-3069	San Jose One South Market	10/17/2017 One South Market St.
04-3068	San Jose Sun Garden	1/18/2018 1566 Monterey Rd.
04-3293	Santa Clara Square	6/27/2019 3249 Coronado Place
04-3093	Santa Monica Mid City	9/7/2017 2025 Wilshire Blvd
04-3219	Seabridge	9/27/2018 1291 South Victoria Avenue
04-3066	Selma	3/30/2017 3120 Floral Ave
04-3012	Shops at Mission Viejo	2/22/2017 VC10 Shops at Mission Viejo
04-3505	SLT	11/26/2019 3640-A Lake Tahoe Blvd
04-2988	South Park	6/29/2017 301 West Olympic Blvd, Suite A
04-3479	South Pasadena	10/21/2020 901 Fair Oaks Ave
04-3648	Southport Town Center	11/24/2020 2155 Town Center Plaza
04-3697	Stadium Crossings	8/31/2020 2085 E Katella Ave
04-3403	Sycamore Hills	8/18/2020 2057 W Baseline Rd
04-3183	Todos Santos	1/30/2019 2002A Salvio Street
04-3227	Tower District	12/13/2018 1601 Broadway, Suite 300
04-2865	Tracy	1/19/2017 2512 Naglee Road
04-2942	Tustin Legacy	10/19/2017 15040 Kensington Park Drive
04-2911	Victory Plaza	4/13/2017 13075 Victory Boulevard, Space 102

City	State	Zip	County
Aliso Viejo	CA	92656	Orange
Baldwin Park	CA	91706	Los Angeles
Banning	CA	92220	Riverside
Berkeley	CA	94704	Alameda
San Ramon	CA	94583	Contra Costa
Costa Mesa	CA	92626	Orange
Fountain Valley	CA	92708	Orange
Cabazon	CA	92230	Riverside
Cerritos	CA	90703	Los Angeles
Chico	CA	95926	Butte
Commerce	CA	90040	Los Angeles
Los Angeles	CA	90017	Los Angeles
Claremont	CA	91711	Los Angeles
Clovis	CA	93611	Fresno
Coronado	CA	92118	San Diego County
Costa Mesa	CA	92627	Orange
Inglewood	CA	90303	Los Angeles
Mission Viejo	CA	92691	Orange
Northridge	CA	91324	Los Angeles
Sacramento	CA	95835	Sacramento
Diamond Bar	CA	91765	Los Angeles
Sacramento	CA	95814	Sacramento
Long Beach	CA	90802	Los Angeles
Anaheim	CA	92807	Orange
Los Angeles	CA	90026	Los Angeles
El Dorado Hills	CA	95762	El Dorado
Elk Grove	CA	95758	Sacramento
Eureka	CA	95501	Humboldt
Foothill Ranch	CA	92610	Orange
Fremont	CA	94539	Alameda
City of Industry	CA	91746	Los Angeles
Fullerton	CA	92832	Orange
Hollister	CA	95023	San Benito
Inglewood	CA	90303	Los Angeles
Imperial Beach	CA	91932	San Diego
Indio	CA	92203	Riverside
Los Angeles	CA	90045	Los Angeles
Lathrop	CA	95330	San Joaquin
Los Banos	CA	93635	Merced
Fresno	CA	93726	Fresno
Los Angeles	CA	90064	Los Angeles
Marina	CA	93933	Monterey
Mission Hills	CA	91345	Los Angeles
Palm Desert	CA	92211	Riverside
Moorpark	CA	93021	Ventura
Bakersfield	CA	93306	Kern

Escondido	CA	92025	San Diego
Northridge	CA	91325	Los Angeles
Oroville	CA	95965	Butte
Pacific Palisades	CA	90272	Los Angeles
Paramount	CA	90723	Los Angeles
Pasadena	CA	91106	Los Angeles
Perris	CA	92571	Riverside
Placentia	CA	92870	Orange
Pleasanton	CA	94566	Alameda
Porterville	CA	93257	Tulare
Lodi	CA	95240	San Joaquin
Rialto	CA	92376	San Bernardino
Sacramento	CA	95832	Sacramento
San Jose	CA	95113	Santa Clara
San Jose	CA	95112	Santa Clara
Santa Clara	CA	95054	Santa Clara
Santa Monica	CA	90403	Los Angeles
Oxnard	CA	93035	Ventura
Selma	CA	93662	Fresno
Mission Viejo	CA	92691	Orange
South Lake Tahoe	CA	96150	El Dorado
Los Angeles	CA	90015	Los Angeles
South Pasadena	CA	91030	Los Angeles
West Sacramento	CA	95691	Yolo
Anaheim	CA	92806	Orange
Upland	CA	91786	San Bernardino
Concord	CA	94518	Contra Costa
Sacramento	CA	95818	Sacramento
Tracy	CA	95304	San Joaquin
Tustin	CA	92782	Orange
North Hollywood	CA	91606	Los Angeles

DEPARTMENT OF ALCOHOLIC BEVERAGE CONTROL
NUMBER OF LICENSES AUTHORIZED
BY CENSUS TRACT

County Name	County Population	County Ratio On Sale	County Ratio Off Sale	Census Tract #	Census Tract Population	On Sale	Off Sale
ORANGE	3,194,332	764	1,686	758.1	3,046	3	1
ORANGE	3,194,332	764	1,686	758.11	3,332	4	1
ORANGE	3,194,332	764	1,686	758.12	6,573	8	3
ORANGE	3,194,332	764	1,686	758.13	5,069	6	3
ORANGE	3,194,332	764	1,686	758.14	3,327	4	1
ORANGE	3,194,332	764	1,686	758.15	5,176	6	3
ORANGE	3,194,332	764	1,686	758.16	3,709	4	2
ORANGE	3,194,332	764	1,686	759.01	4,126	5	2
ORANGE	3,194,332	764	1,686	759.02	6,548	8	3
ORANGE	3,194,332	764	1,686	760	8,371	10	4
ORANGE	3,194,332	764	1,686	761.01	8,933	11	5
ORANGE	3,194,332	764	1,686	761.02	7,487	9	4
ORANGE	3,194,332	764	1,686	761.03	9,137	11	5
ORANGE	3,194,332	764	1,686	762.01	6,772	8	4
ORANGE	3,194,332	764	1,686	762.02	5,812	7	3
ORANGE	3,194,332	764	1,686	762.04	4,492	5	2
ORANGE	3,194,332	764	1,686	762.05	6,847	8	4
ORANGE	3,194,332	764	1,686	762.06	4,517	5	2
ORANGE	3,194,332	764	1,686	762.08	4,999	6	2
ORANGE	3,194,332	764	1,686	863.01	7,474	9	4
ORANGE	3,194,332	764	1,686	863.03	6,212	8	3
ORANGE	3,194,332	764	1,686	863.04	4,847	6	2
ORANGE	3,194,332	764	1,686	863.05	4,006	5	2
ORANGE	3,194,332	764	1,686	863.06	3,658	4	2
ORANGE	3,194,332	764	1,686	864.02	5,651	7	3
ORANGE	3,194,332	764	1,686	864.04	6,546	8	3
ORANGE	3,194,332	764	1,686	864.05	6,578	8	3
ORANGE	3,194,332	764	1,686	864.06	4,330	5	2
ORANGE	3,194,332	764	1,686	864.07	6,488	8	3
ORANGE	3,194,332	764	1,686	865.01	4,848	6	2
ORANGE	3,194,332	764	1,686	865.02	6,551	8	3
ORANGE	3,194,332	764	1,686	866.01	9,584	12	5
ORANGE	3,194,332	764	1,686	866.02	6,131	8	3
ORANGE	3,194,332	764	1,686	867.01	8,876	11	5
ORANGE	3,194,332	764	1,686	867.02	7,094	9	4
ORANGE	3,194,332	764	1,686	868.01	3,267	4	1
ORANGE	3,194,332	764	1,686	868.02	5,913	7	3
ORANGE	3,194,332	764	1,686	868.03	7,478	9	4
ORANGE	3,194,332	764	1,686	869.01	8,725	11	5
ORANGE	3,194,332	764	1,686	869.02	5,614	7	3
ORANGE	3,194,332	764	1,686	869.03	6,861	8	4
ORANGE	3,194,332	764	1,686	870.01	5,537	7	3
ORANGE	3,194,332	764	1,686	870.02	6,922	9	4
ORANGE	3,194,332	764	1,686	871.01	4,635	6	2
ORANGE	3,194,332	764	1,686	871.02	5,816	7	3
ORANGE	3,194,332	764	1,686	871.03	8,470	11	5

Approved Curr.
ON SALE 5 24
OFF SALE 2 4

759.01 - ACTIVE RETAIL LICENSES

Status	License Type	Orig. Iss. Date	Expir. Date	Premises Addr.	Business Name
ACTIVE	48	10/20/1978	6/30/2021	150 N GLASSELL ST, ORANGE, CA 92866 Census Tract: 0759.01	OHARAS PUB INC
ACTIVE	48	12/2/1985	7/31/2021	207 W CHAPMAN AVE, ORANGE, CA 92866 Census Tract: 0759.01	PAULS COCKTAILS
ACTIVE	41	1/9/1989	8/31/2021	129 W CHAPMAN AVE, ORANGE, CA 92866 Census Tract: 0759.01	BYBLOS CAFE INC
ACTIVE	41	10/3/2001	9/30/2021	264 N GLASSELL ST, ORANGE, CA 92866 Census Tract: 0759.01	RUTABEGORZ
ACTIVE	41	5/9/2001	5/31/2021	156 N GLASSELL ST, ORANGE, CA 92866 Census Tract: 0759.01	ZITOS PIZZA
ACTIVE	41	5/26/2004	4/30/2022	227 E CHAPMAN AVE, STE F, ORANGE, CA 92866-1534 Census Tract: 0759.01	RENATA'S CAFE ITALIANO
ACTIVE	48	12/14/2004	11/30/2021	223 W CHAPMAN AVE, ORANGE, CA 92866-1303 Census Tract: 0759.01	DISTRICT LOUNGE
ACTIVE	40	4/23/2007	3/31/2022	121 N LEMON ST, ORANGE, CA 92866 Census Tract: 0759.01	TACO ADOBE
ACTIVE	41	4/1/2009	3/31/2022	154 N GLASSELL ST, ORANGE, CA 92866-1407 Census Tract: 0759.01	JALAPENOS GRILL
ACTIVE	47	4/14/2011	3/31/2022	186 N ATCHISON ST, ORANGE, CA 92866-1301 Census Tract: 0759.01	RUBYS DINER
ACTIVE	41	9/21/2011	9/30/2021	201 N GLASSELL ST, ORANGE, CA 92866-1408 Census Tract: 0759.01	FILLING STATION CAFE INC THE
ACTIVE	41	8/21/2012	7/31/2021	128 N GLASSELL ST, ORANGE, CA 92866-1407 Census Tract: 0759.01	SMOQUED BBQ
ACTIVE	41	11/14/2013	10/31/2021	143 N GLASSELL ST, ORANGE, CA 92866-1406 Census Tract: 0759.01	PROVISIONS DELI & BOTTLE SHOP
ACTIVE	20	12/11/2013	11/30/2021	608 E PALM AVE, UNIT A, ORANGE, CA 92866-1138 Census Tract: 0759.01	PALM MARKET

ACTIVE	41	3/3/2015	2/28/2022	153-155 N GLASSELL ST, ORANGE, CA 92866-1406 Census Tract: 0759.01	RAMISONS INC
ACTIVE	41	5/20/2015	4/30/2022	161 N GLASSELL ST, ORANGE, CA 92866-1406 Census Tract: 0759.01	HANANA RAMEN
ACTIVE	58	8/30/2016	7/31/2021	80 PLAZA SQ, ORANGE, CA 92866-1433 Census Tract: 0759.01	WALL THE
ACTIVE	41	8/30/2016	7/31/2021	80 PLAZA SQ, ORANGE, CA 92866-1433 Census Tract: 0759.01	WALL THE
ACTIVE	77	1/11/2016	12/31/2021	123-129 N CYPRESS ST, ORANGE, CA 92866-1309 Census Tract: 0759.01	CHAPMAN CRAFTED BEER
ACTIVE	84	1/11/2016	12/31/2021	123-129 N CYPRESS ST, ORANGE, CA 92866-1309 Census Tract: 0759.01	CHAPMAN CRAFTED BEER
ACTIVE	47	1/20/2016	12/31/2021	149 N GLASSELL ST, ORANGE, CA 92866-1406 Census Tract: 0759.01	JAXONS
ACTIVE	41	11/22/2017	10/31/2021	106 N GLASSELL ST, ORANGE, CA 92866-1407 Census Tract: 0759.01	PANDOR BAKERY & BISTRO
ACTIVE	58	7/18/2017	6/30/2021	513 E CHAPMAN AVE, ORANGE, CA 92866-1602 Census Tract: 0759.01	WOODY'S DINER
ACTIVE	47	7/18/2017	6/30/2021	513 E CHAPMAN AVE, ORANGE, CA 92866-1602 Census Tract: 0759.01	WOODY'S DINER
ACTIVE	21	12/19/2017	11/30/2021	493 N GLASSELL ST, ORANGE, CA 92866-1033 Census Tract: 0759.01	HOOVES LIQUOR
ACTIVE	41	6/11/2018	5/31/2022	152 N GLASSELL ST, STE B, ORANGE, CA 92866-1468 Census Tract: 0759.01	THAI TOWNE EATERY
ACTIVE	21	7/17/2018	6/30/2022	835 W CHAPMAN AVE, ORANGE, CA 92868-2822 Census Tract: 0759.01	ROYAL LIQUOR
ACTIVE	20	8/3/2018	7/31/2021	480 N GLASSELL ST, ORANGE, CA 92866-1034 Census Tract: 0759.01	UNIVERSITY FOOD MART
ACTIVE	51	11/15/2019	10/31/2021	211 E CHAPMAN AVE, ORANGE, CA 92866-1505 Census Tract: 0759.01	ELKS LODGE ORANGE 1475
ACTIVE	75	3/27/2020	2/28/2022	114 N GLASSELL ST, ORANGE, CA 92866-1407 Census Tract: 0759.01	BREWERY 1886

ACTIVE 47 12/13/2019 11/30/2021 122 N GLASSELL ST, ORANGE, CA 92866-1407 CITRUS CITY GRILLE
Census Tract: 0759.01

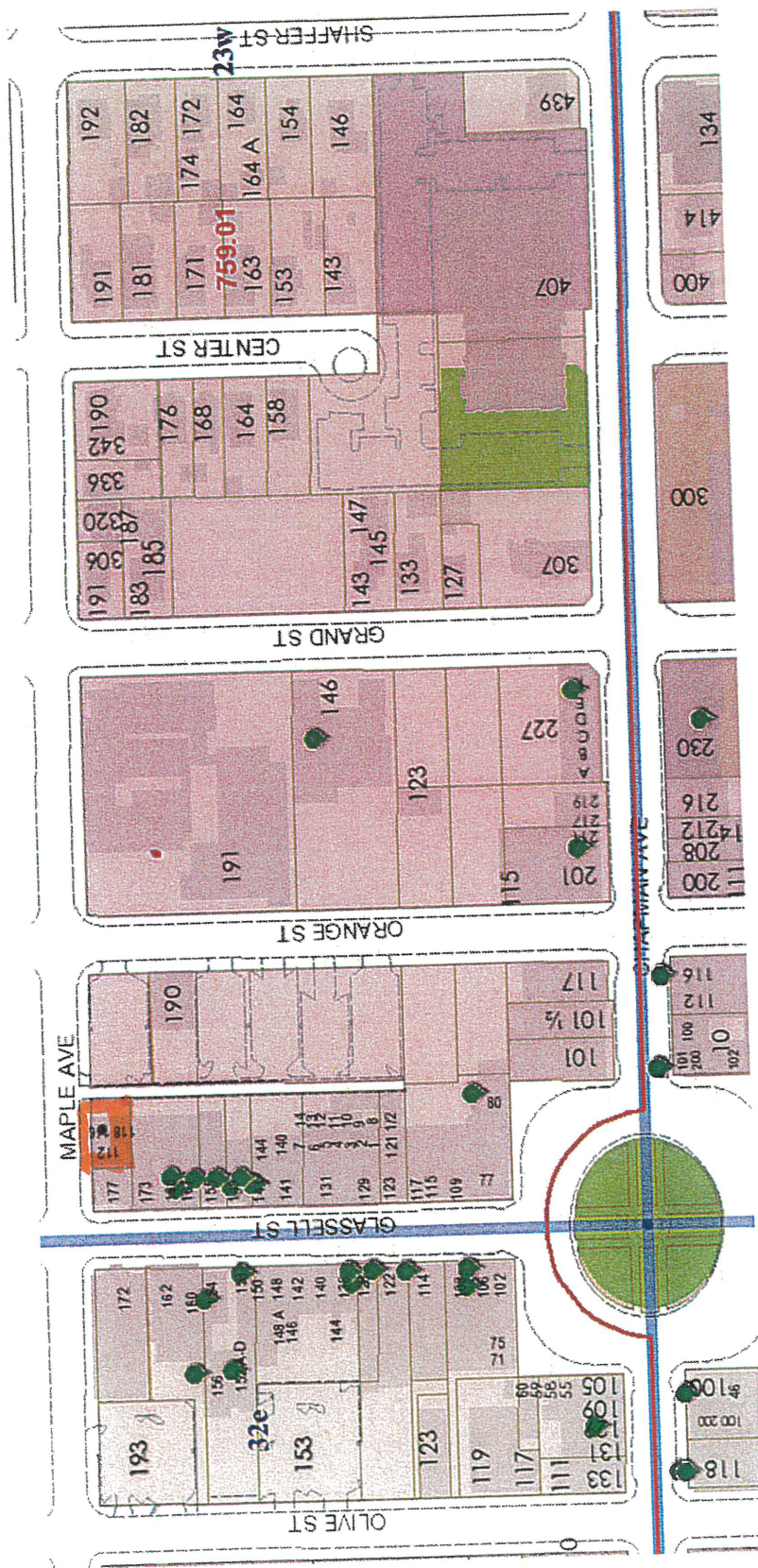

City of Orange

2020 Part I Crime & Part II Arrest

Average # for all RD's -74

RD	PART 1 Crime	PART 2 Arrests	TOTAL	% of Avg
61	163	257	420	464%
51	77	317	394	430%
12	102	230	332	346%
035E	89	197	286	284%
077S	113	103	216	190%
013S	25	181	206	177%
032E	43	153	196	163%
022E	79	99	178	139%
31	68	106	174	134%
76	75	74	149	100%
021W	78	70	148	99%
43	60	84	144	94%
065E	48	93	141	90%
87	89	49	138	85%
022W	41	96	137	84%
24	72	61	133	79%
99	0	125	125	68%
036S	43	76	119	60%
71	81	37	118	59%
045E	65	47	112	51%
044N	36	67	103	38%
017E	37	60	97	30%
055W	47	49	96	29%
057S	35	61	96	29%
054W	56	39	95	28%
023W	34	60	94	26%
11	41	52	93	25%
041E	57	34	91	22%
33	45	45	90	21%
025E	53	35	88	18%
016E	28	57	85	14%
013N	45	39	84	13%
055E	21	58	79	6%
047E	41	34	75	1%
077N	35	40	75	1%
032W	26	48	74	-1%
026S	34	38	72	-3%
15	24	44	68	-9%

56	35	33	68	-9%
023E	33	35	68	-9%
045W	33	35	68	-9%
065W	30	36	66	-11%
46	33	29	62	-17%
034N	38	24	62	-17%
035W	19	43	62	-17%
017W	30	28	58	-22%
041W	46	12	58	-22%
037E	27	28	55	-26%
027E	33	21	54	-27%
047W	32	21	53	-29%
067N	23	20	43	-42%
026N	21	20	41	-45%
164	28	11	39	-48%
016W	21	10	31	-58%
025W	14	17	31	-58%
054E	18	13	31	-58%
057N	13	18	31	-58%
66	14	15	29	-61%
036N	8	21	29	-61%
067S	18	11	29	-61%
134	17	11	28	-62%
027W	20	7	27	-64%
084S	17	9	26	-65%
117W	11	15	26	-65%
044S	17	7	24	-68%
117N	14	8	22	-70%
97	5	15	20	-73%
064S	10	10	20	-73%
127S	14	5	19	-74%
137	12	4	16	-78%
074S	9	6	15	-80%
14	9	2	11	-85%
034S	8	3	11	-85%
127N	3	7	10	-87%
114	4	5	9	-88%
117E	6	3	9	-88%
147	6	2	8	-89%
064N	3	3	6	-92%
074N	4	2	6	-92%
084N	5	1	6	-92%
94	2	3	5	-93%
154	1	4	5	-93%

144	2	2	4	-95%
174	2	2	4	-95%
18	0	3	3	-96%
124	1	2	3	-96%
184	1	2	3	-96%
021E	2	1	3	-96%
037W	3	0	3	-96%
48	0	2	2	-97%
157	0	2	2	-97%
38	0	0	0	-100%

Date_Arrest	DR#	Arrest_Address	RD	UCR Code	Penal Code	Statute Descript
1/1/20 3:05	20-01-0006	N CAMBRIDGE ST @ E WALNUT AVE	023W	21	23152 (A)	DUI ALCOHOL
1/6/20 18:43	20-01-0184	407 E Chapman Ave	023W	15	417 (A)(1)	EXHIBIT DEADLY WEAPON OTHER THAN FIREARM
1/11/20 4:28	20-01-0316	1 Plaza Square	023W	21	23152 (A)	DUI ALCOHOL
1/20/20 22:22	20-01-0629	407 E Chapman Ave	023W	26	11550 (A)	USE/UNDER INFLUENCE OF CONTROLLED SUBSTANCE
1/24/20 16:04	20-01-0754	102 N Glassell	023W	10	470 B	POSSESS DRIVER'S LICENSE/IDENTIFICATION TO COMMIT FORGERY
2/4/20 11:35	20-02-0122	393 N Glassell St	023W	14	594 (B)(1)	VANDALISM [\$400 OR MORE]
2/9/20 17:58	20-02-0291	E CHAPMAN @ N GRAND	023W	26	11550 (A)	USE/UNDER INFLUENCE OF CONTROLLED SUBSTANCE
2/12/20 23:25	20-02-0388	E Chapman Ave @ N Shaffer St	023W	21	23152 (A)	DUI ALCOHOL
2/19/20 14:24	20-02-0625	407 E Chapman Ave	023W	18f.	11362.3 (A)(1)	SMOKE MARIJUANA IN PUBLIC
2/24/20 0:19	20-02-0804	1 Plaza Square	023W	26	11364 (A)	POSSESS UNLAWFUL PARAPHERNALIA
2/23/20 20:37	20-02-0799	E Walnut Ave @ N Center St	023W	26	11364 (A)	POSSESS UNLAWFUL PARAPHERNALIA
2/28/20 12:14	20-02-0975	407 E Chapman Ave	023W	15	21310	CARRY CONCEALED DIRK OR DAGGER
3/3/20 20:52	20-03-0105	364 N Cambridge St	023W	23	647 (F)	DISORDERLY CONDUCT:ALCOHOL
3/14/20 14:26	20-03-0477	101 E Chapman Ave	023W	26	11550 (A)	USE/UNDER INFLUENCE OF CONTROLLED SUBSTANCE

Alcohol
Related

DUI 15
647 f 1
16

3/18/20 0:19	20-03-0561	388 N SHAFFER ST	023W	26	381 B	POSSESS NITROUS OXIDE
3/17/20 22:54	20-03-0561	388 N SHAFFER ST	023W	26	381 B	POSSESS NITROUS OXIDE
3/18/20 0:19	20-03-0561	388 N SHAFFER ST	023W	26	381 B	POSSESS NITROUS OXIDE
4/10/20 8:22	20-04-0185	127 N Pine St	023W	26	602 (M)	TRESPASS:OCCUPY PROPERTY WITHOUT CONSENT
4/19/20 21:47	20-04-0422	1 PLAZA SQUARE	023W	21	23152 (A)	DUI ALCOHOL
4/28/20 0:36	20-04-0632	E Chapman Ave @ N Orange St	023W	18g.	11377 (A)	POSSESS CONTROLLED SUBSTANCE
5/7/20 0:12	20-05-0164	407 E Chapman Ave	023W	18g.	11377 (A)	POSSESS CONTROLLED SUBSTANCE
5/6/20 8:11	20-05-0131	N SHAFFER ST @ E PALM AVE	023W	26	11364 (A)	POSSESS UNLAWFUL PARAPHERNALIA
5/18/20 9:24	20-05-0456	407 E CHAPMAN	023W	26	69	OBSTRUCT/RESIST EXECUTIVE OFFICER
5/25/20 17:57	20-05-0702	211 E MAPLE	023W	21	23152 (A)	DUI ALCOHOL
6/2/20 22:29	20-06-0060	237 N HARWOOD ST	023W	26	148 (A) (1)	RESIST/DELAY/OBSTRUCT POLICE/PUBLIC OFFICER/EMERGENCY TEC
6/5/20 7:59	20-06-0116	174 N SHAFFER ST	023W	21	23152 (F)	DUI ANY DRUG
6/17/20 0:18	20-06-0522	291 N Shaffer St	023W	04e.	273.5(A)	INFLECT CORPORAL INJURY ON SPOUSE/COHABITANT

6/18/20 2:35	20-06-0560	N Grand St @ E Chapman Ave	023W	21	23152 (A)/(B)	DUI ALCOHOL/0.08 PERCENT
7/3/20 8:08	20-07-0084	183 N Grand St	023W	18g.	11377 (A)	POSSESS CONTROLLED SUBSTANCE
7/5/20 9:44	20-07-0160	277 N Glassell St	023W	99	VC 12500(B)	DRIVING WITHOUT DRIVERS LICENSE - MOTORCYCLE
7/8/20 21:17	20-07-0304	191 N Orange St	023W	24	647 (E)	DISORDERLY CONDUCT: LODGE WITHOUT OWNERS CONSENT
7/16/20 0:11	20-07-0539	1 Plaza Square	023W	21	23152 (A)/(B)	DUI ALCOHOL/0.08 PERCENT
7/25/20 9:37	20-07-0812	407 E Chapman Ave	023W	13	496 (A)	RECEIVE/ETC KNOWN STOLEN PROPERTY
7/26/20 11:18	20-07-0849	190 N Center St	023W	26	11364 (A)	POSSESS UNLAWFUL PARAPHERNALIA
8/5/20 10:06	20-08-0148	1 University Dr	023W	26	11364 (A)	POSSESS UNLAWFUL PARAPHERNALIA
8/12/20 17:06	20-08-0429	112 E Chapman Ave	023W	99	VC 23154(A)	VIOLATION OF DUI PROBATION
8/13/20 17:29	20-08-0458	200 N Grand St	023W	26	11364 (A)	POSSESS UNLAWFUL PARAPHERNALIA
8/16/20 0:55	20-08-0542	1 Plaza Square	023W	04e.	273.5(A)	INFLECT CORPORAL INJURY ON SPOUSE/COHABITANT
8/19/20 12:58	20-08-0659	215 N Grand St	023W	26	602 (O)	TRESPASS: REFUSE TO LEAVE PROPERTY
8/27/20 1:47	20-08-0914	1 Plaza Square	023W	21	23152 (A)/(B)	DUI ALCOHOL/0.08 PERCENT
8/30/20 4:54	20-08-1034	N Shaffer St @ E Chapman Ave	023W	99	VC 12500(A)	UNLICENSED DRIVER
9/4/20 22:53	20-09-0121	E CHAPMAN AVE @ S CENTER ST	023W	13	496 D(A)	POSSESS STOLEN VEHICLE/VESSEL/ETC

9/6/20 1:31	20-09-0156	1 Plaza Square	023W	21	23152 (A)/(B)	DUI ALCOHOL/0.08 PERCENT
9/11/20 20:34	20-09-0331	N Glassell St @ E Maple Ave	023W	26	11364 (A)	POSSESS UNLAWFUL PARAPHERNALIA
9/15/20 9:40	20-09-0446	222 University Dr.	023W	17	243.4(E)(1)	TOUCH PERSON INTIMATELY AGAINST WILL FOR SEXUAL AROUSAL/E
9/18/20 9:20	20-09-0574	N SHAFFER ST @ E PALM AVE	023W	26	10851(A)	STOLEN IN ANOTHER JURISDICTION/RECOVERED LOCAL
9/27/20 3:01	20-09-0852	E Walnut Ave @ N Center St	023W	21	23152 (A)/(B)	DUI ALCOHOL/0.08 PERCENT
9/27/20 3:13	20-09-0853	N CAMBRIDGE ST @ E PALM AVE	023W	21	23152 (A)/(B)	DUI ALCOHOL/0.08 PERCENT
9/27/20 21:34	20-09-0875	630 E Walnut Ave	023W	26	11364 (A)	POSSESS UNLAWFUL PARAPHERNALIA
10/2/20 12:00	20-10-0038	608 E. Palm Ave.	023W	18g.	11375(B)(2)	POSSESS CONTROLLED SUBSTANCE W/O PRESCRIPTION
10/21/20 19:42	20-10-0647	314 N Shaffer St	023W	26	422	THREATEN CRIME W/INTENT TO TERRORIZE
11/6/20 18:19	20-11-0211	407 E Chapman Ave	023W	26	11364 (A)	POSSESS UNLAWFUL PARAPHERNALIA
11/7/20 22:33	20-11-0250	1 Plaza Square	023W	21	23152 (A)/(B)	DUI ALCOHOL/0.08 PERCENT
11/8/20 0:43	20-11-0253	1 Plaza Square	023W	99	VC 12500 (A)	DRIVE W/O LICENSE
11/17/20 9:46	20-11-0537	191 N Orange St	023W	17	647 (A)	DISORDERLY CONDUCT:SOLICIT LEWD ACT

11/16/20 11:25	20-11-0514	E Chapman Ave @ N Grand St	023W	04e.	243 (E)(1)	BATTERY:SPOUSE/EX SPOUSE/DATE/ETC
11/29/20 12:27	20-11-0874	E CHAPMAN AVE @ N GRAND ST	023W	18c.	11378	POSSESS CONTROLLED SUBSTANCE FOR SALE
12/13/20 21:37	20-12-0419	407 E Chapman Ave	023W	17	243.4(A)	SEXUAL BATTERY
12/18/20 15:50	20-12-0592	485 N Center St	023W	21	23152 (A)	DUI ALCOHOL
12/26/20 16:00	20-12-0803	109 N GLASSELL ST	023W	14	594 (B)(2)(A)	VANDALISM LESS THAN \$400