



CREATING VISUAL IMPACT

Old Towne

SCOPE OF WORK

- A** | Proposed New Reversed Halo Channel Letters Mounted Onto Existing Canopy
- B** | Proposed New Reversed Halo Channel Letters Mounted Onto Existing Double Sided Pylon Sign

The design is per 2022 California Building Standards Code:

- 2022 California Building Code
- 2022 California Electrical Code
- 2022 California Building Energy Efficiency Standards

LEGEND

- Conceptual Plan
- Permit Plan
- Production Plan
- Install Plan
- New Proposed
- Reface/ Refurbish
- Existing Sign To Be Removed
- Existing Sign To Remain

VICINITY MAP

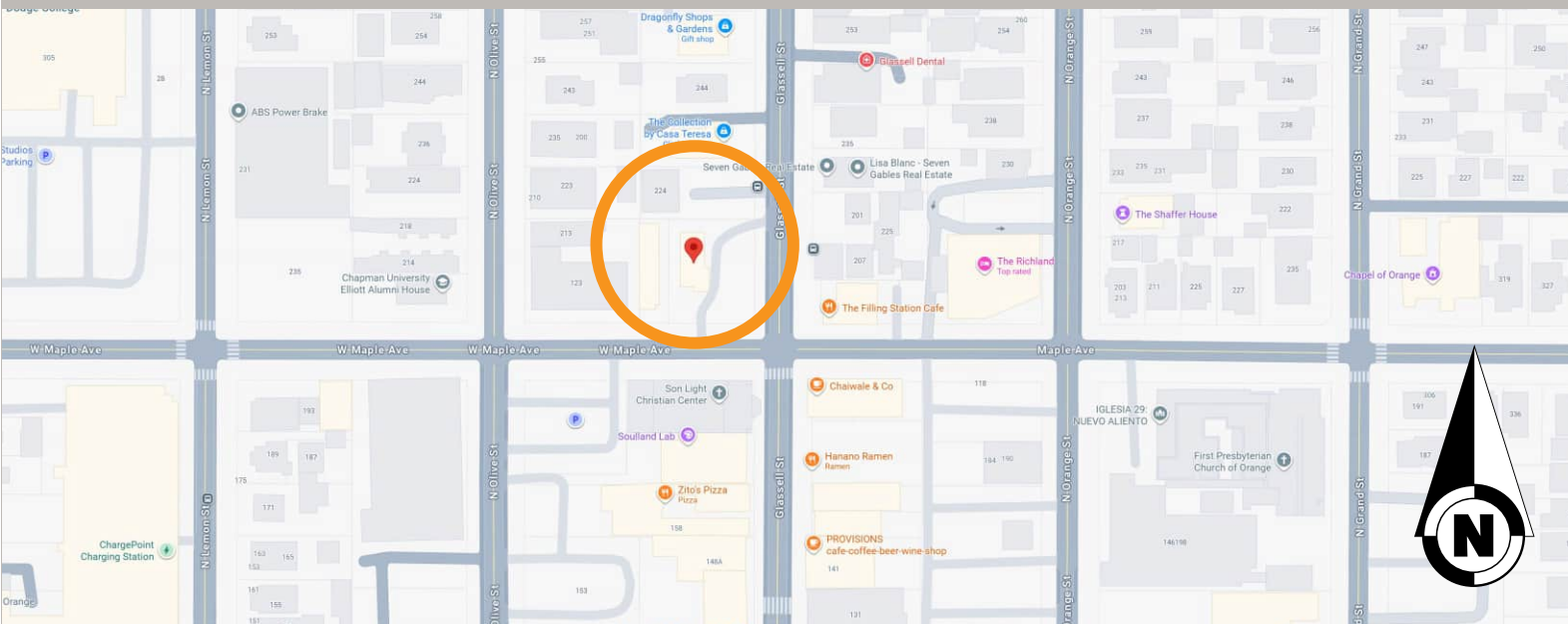

PROJECT



202 N Glassell Street, Orange, CA 92866
SIGN PACKAGE

SIGN CODE

PRIMARY WALL SIGNS:

- A wall sign is limited to a maximum of one square foot for each lineal foot of the tenant's street frontage
- Maximum total sign length is 20 feet
- Letter height shall be no more 24 inches tall
- Multiple lines of text are permitted, provided the sign area requirements are met

AERIAL PHOTO

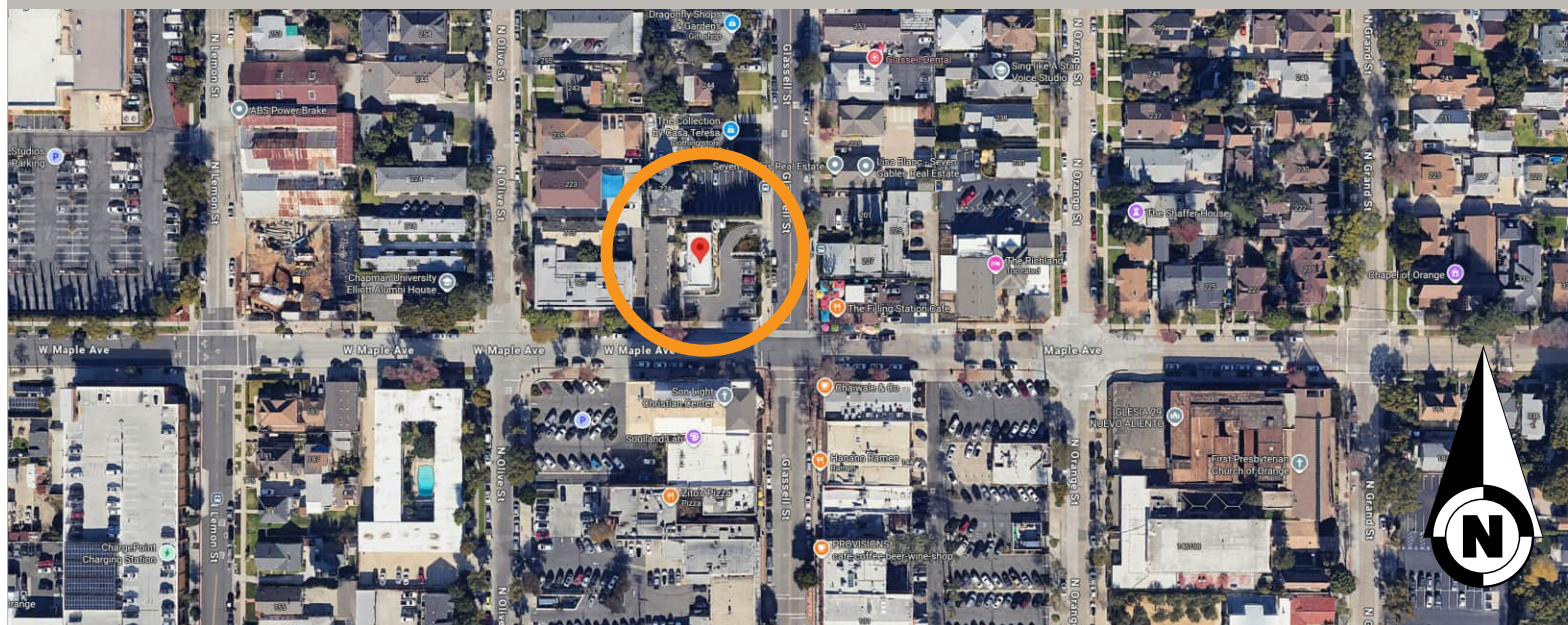

COLOR DISCLAIMER

Due to the limitations of desktop scanners and the relative inconsistencies of various display monitors and printers, the colors you see on your screen or on paper may not be a totally accurate reproduction of the actual product. We strive to make our colors as accurate as possible, but screen and printed images are intended as a guide only and should not be regarded as absolutely correct. Site conditions and on site lighting can also affect how the product appears (i.e. LED, different fluorescent bulbs & natural light). We recommend that you request a color sample as CMYK (Cyan, Magenta, Yellow & Black) are the colors used in the printing process, whereas RGB (Red, Green & Blue) are the colors used by screen displays such as your monitor. For this reason and due to variations introduced by light and various equipment, the colors on your screen or a print may not exactly match the finished product.

IF YOU WOULD LIKE TO SEE A SAMPLE OF ANY COLOR, PLEASE REQUEST AN ACTUAL SAMPLE FROM YOUR SALESPERSON OR PROJECT MANAGER. WITHOUT A SIGNED COLOR SAMPLE, FX SIGNS, ITS VENDORS AND AFFILIATES ARE NOT RESPONSIBLE FOR DIFFERENCES, REAL OR PERCEIVED, BETWEEN THE WAY YOUR PRODUCT APPEARS ON SCREEN OR PAPER AND THE FINAL PRODUCT.



CREATING VISUAL IMPACT

12155 MAGNOLIA AVE BLDG 11-A
RIVERSIDE, CA 92503
(951) 689-0270
FXCVI.COM
LIC# 1014540

SITE LOCATION:

PHILZ COFFEE

202 N Glassell St
Orange, CA 92886

CLIENT:

PHILZ COFFEE
Email: info@philzcoffee.com

Rob George
Email: robgeorge@philzcoffee.com
Phone: (408) 838-6451

PROPERTY OWNER / MGT

CREATED DATE:

May 30, 2025

JOB NUMBER:

1895 R11 | 250006 City R01

SALES REP:
FL

DRAWN BY:
SP

REVISION: R11
02 23 2026

REVISED BY: SP

CLIENT APPROVAL:

DATE:

LANDLORD APPROVAL:

DATE:

Approved For Construction

ACCOUNT MANAGER:

DATE:

DESIGNER:

DATE:

PRODUCTION:

DATE:

SHEET: 2 OF 11

© 2024 - This original design(s) is the exclusive property of FX SIGNS INC. and is protected by federal copyrights laws. Any reproduction or construction of a sign similar to the one embodied herein is expressly prohibited without prior written consent of FX SIGNS INC.

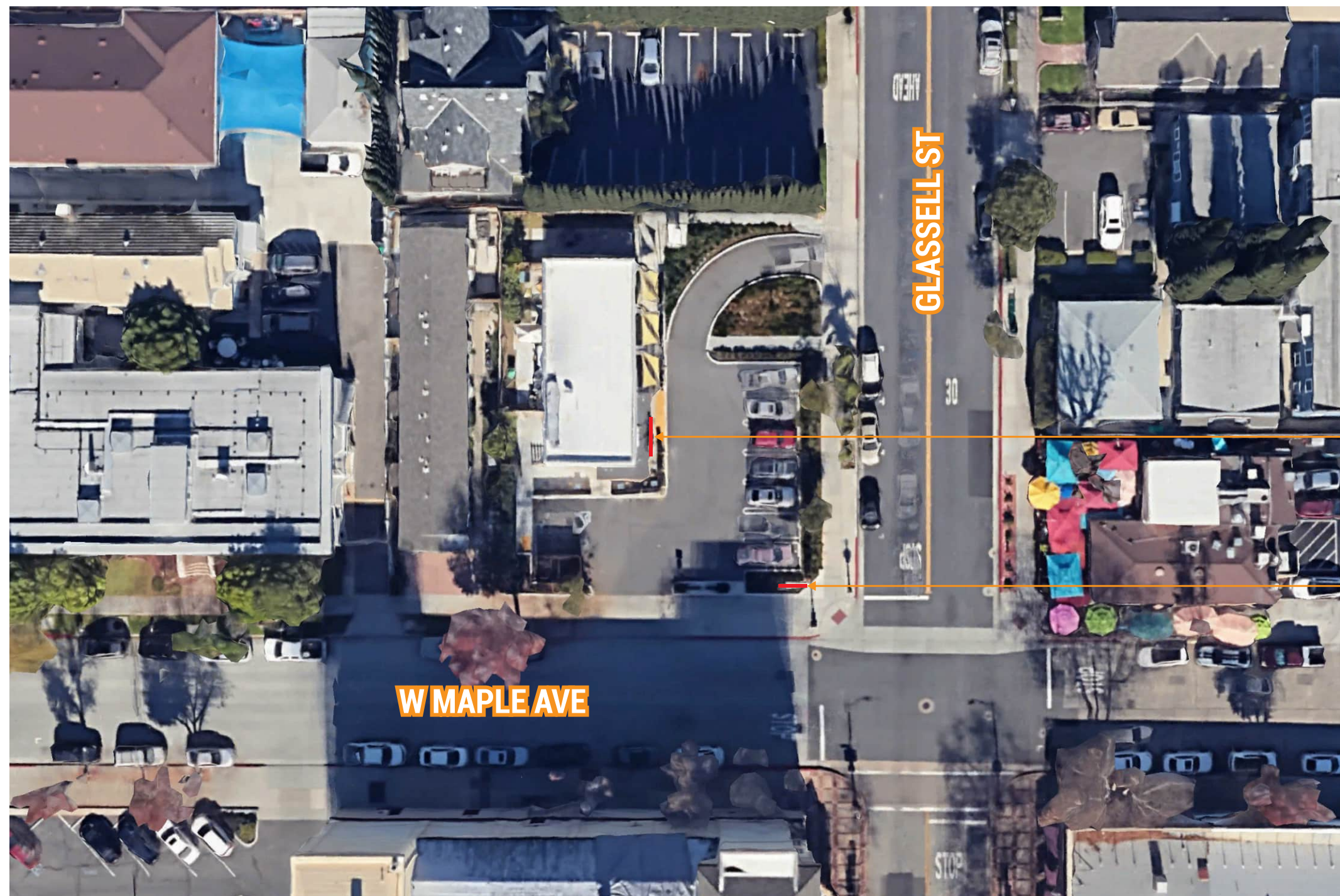

1 SITE PLAN

NOT TO SCALE

LEGEND

- Conceptual Plan
- Permit Plan
- Production Plan
- Install Plan
- New Proposed
- Reface/ Refurbish
- Existing Sign To Be Removed
- Existing Sign To Remain





1 3D RENDERING

NOT TO SCALE

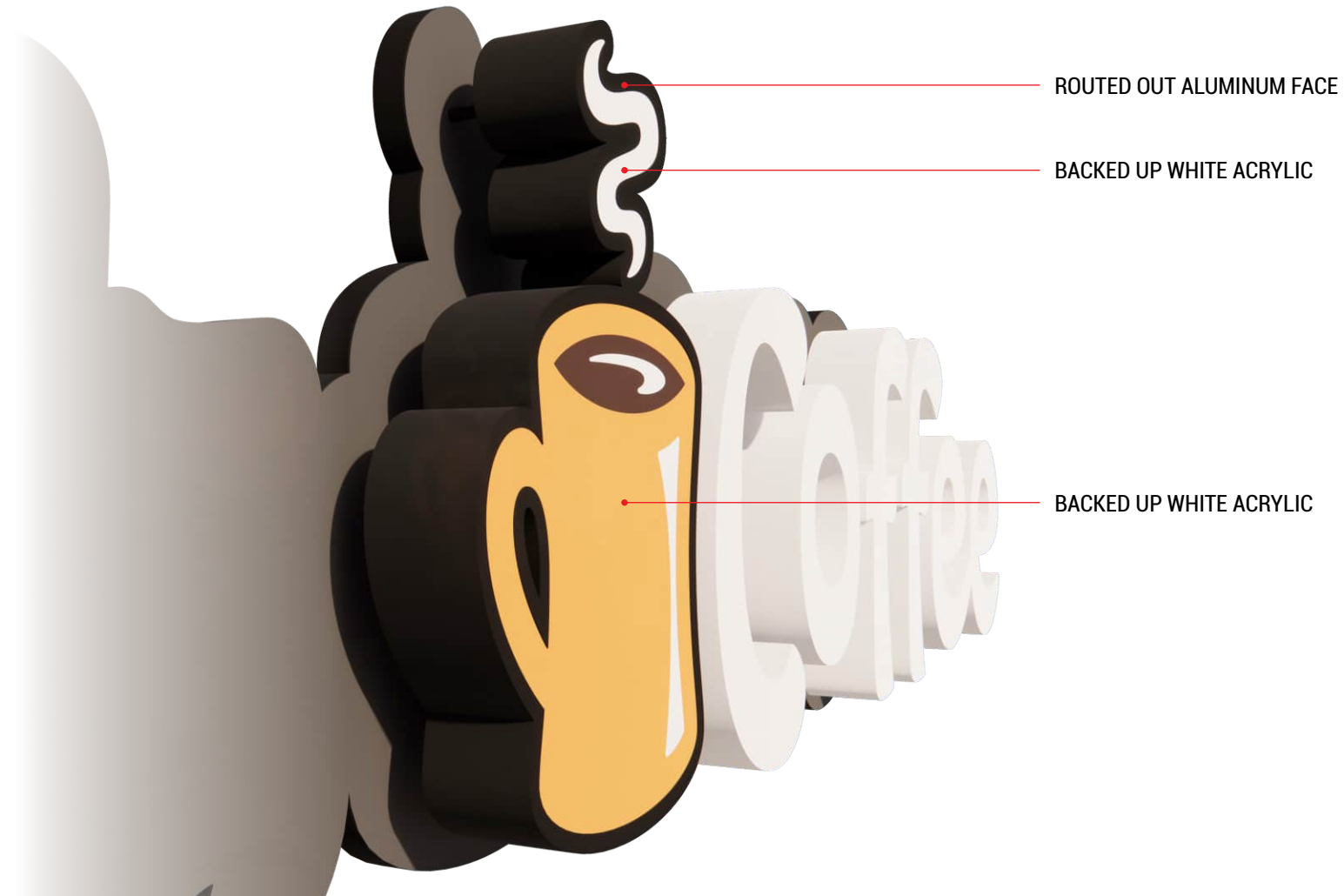

2 3D RENDERING

NOT TO SCALE

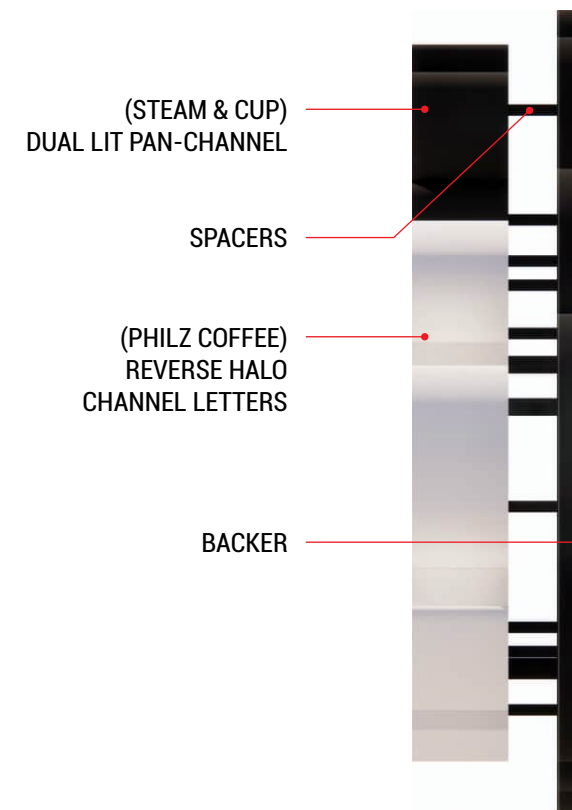

3 SIDE VIEW

SCALE: NTS



CREATING VISUAL IMPACT

12155 MAGNOLIA AVE BLDG 11-A
RIVERSIDE, CA 92503
(951) 689-0270
FXCVI.COM
LIC# 1014540

SITE LOCATION:

PHILZ COFFEE

202 N Glassell St
Orange, CA 92886

CLIENT:

PHILZ COFFEE
Email: info@philzcoffee.com

Rob George
Email: robgeorge@philzcoffee.com
Phone: (408) 838-6451

PROPERTY OWNER / MGT

CREATED DATE:

May 30, 2025

JOB NUMBER:

1895 R11 | 250006 City R01

SALES REP:
FL

DRAWN BY:
SP

REVISION: R11
02 23 2026

REVISED BY: SP

CLIENT APPROVAL:

DATE:

LANDLORD APPROVAL:

DATE:

Approved For Construction

ACCOUNT MANAGER:

DATE:

DESIGNER:

DATE:

PRODUCTION:

DATE:

SHEET: **3** OF **11**

© 2024 - This original design(s) is the exclusive property of FX SIGNS INC. and is protected by federal copyrights laws. Any reproduction or construction of a sign similar to the one embodied herein is expressly prohibited without prior written consent of FX SIGNS INC.

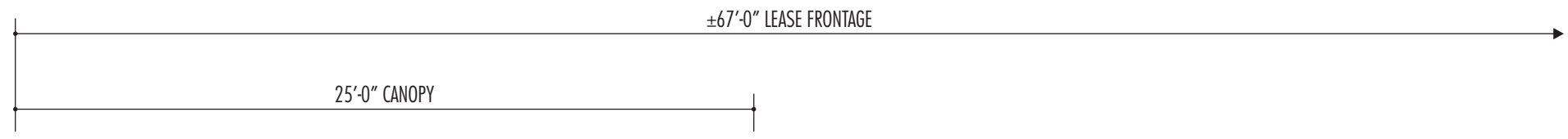

A EAST ELEVATION (PROPOSED)

SCALE: 3/16" = 1'-0"



1 CURRENT EAST ELEVATION

NOT TO SCALE

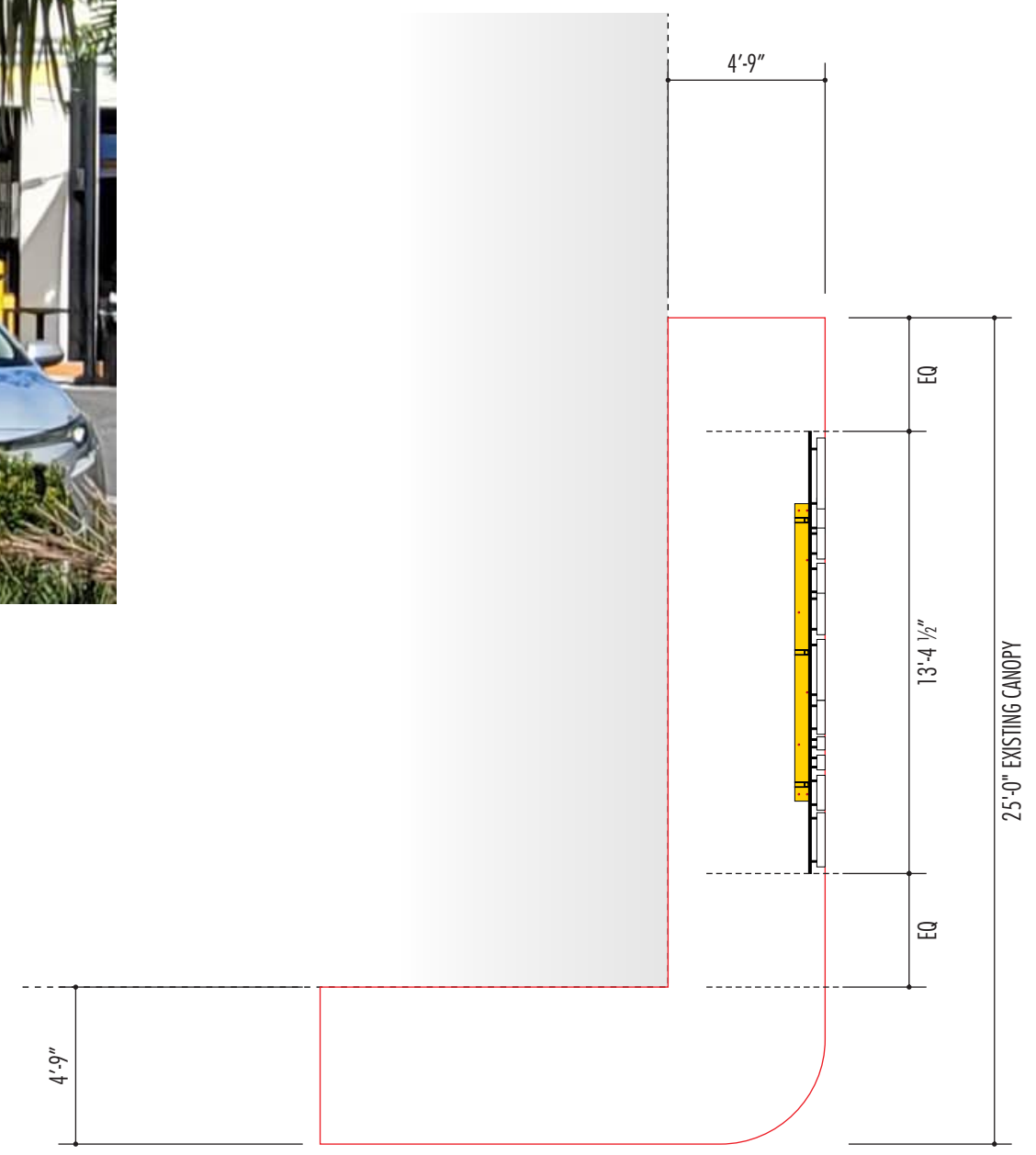

2 PLAN VIEW SIGN PLACEMENT

SCALE: 3/16" = 1'-0"



CREATING VISUAL IMPACT

12155 MAGNOLIA AVE BLDG 11-A
RIVERSIDE, CA 92503
(951) 689-0270
FXCVI.COM
LIC# 1014540

SITE LOCATION:

PHILZ COFFEE

202 N Glassell St
Orange, CA 92886

CLIENT:

PHILZ COFFEE
Email: info@philzcoffee.com

Rob George
Email: robgeorge@philzcoffee.com
Phone: (408) 838-6451

PROPERTY OWNER / MGT

CREATED DATE:

May 30, 2025

JOB NUMBER:

1895 R11 | 250006 City R01

SALES REP: FL
DRAWN BY: SP

REVISION: R11
02 23 2026
REVISED BY: SP

CLIENT APPROVAL: DATE:

LANDLORD APPROVAL: DATE:

Approved For Construction

ACCOUNT MANAGER: DATE:

DESIGNER: DATE:

PRODUCTION: DATE:

SHEET: **4** OF **11**

© 2024 - This original design(s) is the exclusive property of FX SIGNS INC. and is protected by federal copyrights laws. Any reproduction or construction of a sign similar to the one embodied herein is expressly prohibited without prior written consent of FX SIGNS INC.

±67'-0" LEASE FRONTAGE

7'-2 1/2"
EXISTING CABINET

6'-8 7/8"



12'-4"

16'-1" EXISTING POLE

B SOUTH ELEVATION (PROPOSED)

SCALE: 3/16" = 1'-0"

EXISTING POLE
TO BE RE-PAINTED BY OTHERS
"BENJAMIN MOORE YELLOW 2022-10"



1 CURRENT SOUTH ELEVATION

NOT TO SCALE



CREATING VISUAL IMPACT

12155 MAGNOLIA AVE BLDG 11-A
RIVERSIDE, CA 92503
(951) 689-0270
FXCVI.COM
LIC# 1014540

SITE LOCATION:

PHILZ COFFEE

202 N Glassell St
Orange, CA 92886

CLIENT:

PHILZ COFFEE
Email: info@philzcoffee.com

Rob George
Email: robgeorge@philzcoffee.com
Phone: (408) 838-6451

PROPERTY OWNER / MGT

CREATED DATE:

May 30, 2025

JOB NUMBER:

1895 R11 | 250006 City R01

SALES REP:

FL

DRAWN BY:

SP

REVISION: R11
02 23 2026

REVISED BY: SP

CLIENT APPROVAL:

DATE:

LANDLORD APPROVAL:

DATE:

Approved For Construction

ACCOUNT MANAGER:

DATE:

DESIGNER:

DATE:

PRODUCTION:

DATE:

SHEET: **5** OF **11**

© 2024 - This original design(s) is the exclusive property of FX SIGNS INC. and is protected by federal copyrights laws. Any reproduction or construction of a sign similar to the one embodied herein is expressly prohibited without prior written consent of FX SIGNS INC.

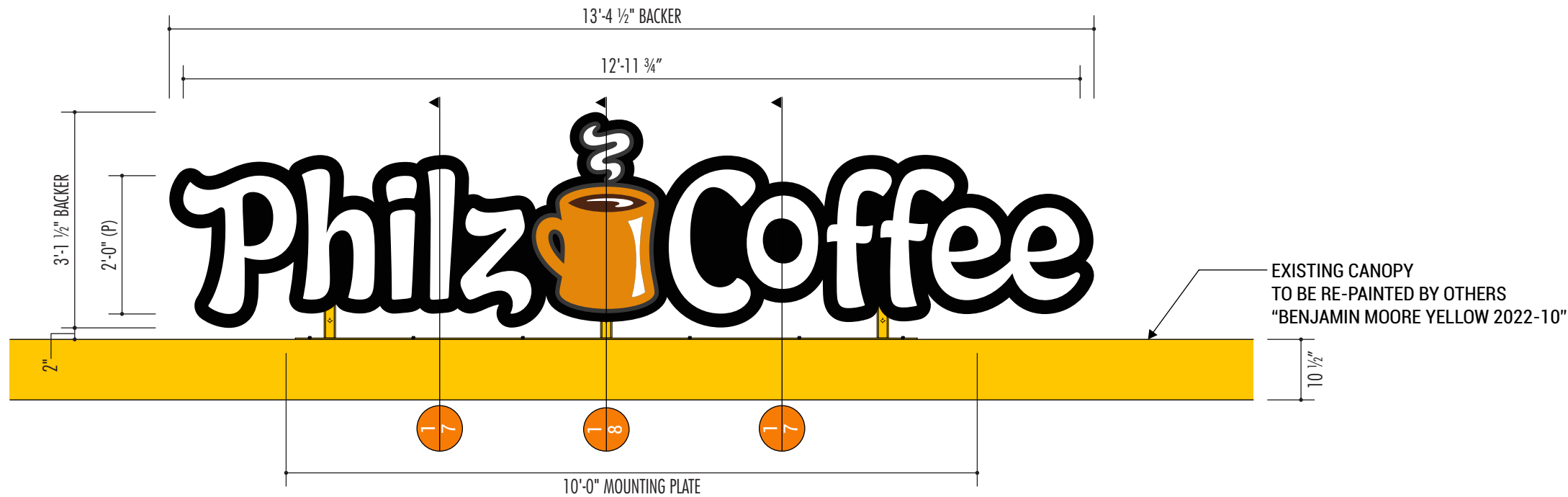

MATERIALS SCHEDULE

- M1** 3/16" Thick White Acrylic
- M2** 3/16" Clear Lexan Backs
- M3** 1" Trimcaps Pre-coat White
- M4** .063 Aluminum
- M5** .090 Aluminum

PAINT SCHEDULE

- P1** Clear Matte Finish
- P2** 3M 3630-59 Dark Brown
- P3** 3M 3630-84 Tangerine



CREATING VISUAL IMPACT

12155 MAGNOLIA AVE BLDG 11-A
RIVERSIDE, CA 92503
(951) 689-0270
FXCVI.COM
LIC# 1014540

SITE LOCATION:

PHILZ COFFEE

202 N Glassell St
Orange, CA 92886

CLIENT:

PHILZ COFFEE
Email: info@philzcoffee.com

Rob George
Email: robgeorge@philzcoffee.com
Phone: (408) 838-6451

PROPERTY OWNER / MGT

CREATED DATE:

May 30, 2025

JOB NUMBER:

1895 R11 | 250006 City R01

SALES REP:

FL

DRAWN BY:

SP

REVISION: R11
02 23 2026

REVISED BY: SP

CLIENT APPROVAL:

DATE:

LANDLORD APPROVAL:

DATE:

Approved For Construction

ACCOUNT MANAGER:

DATE:

DESIGNER:

DATE:

PRODUCTION:

DATE:

SHEET: **6** OF **11**

© 2024 - This original design(s) is the exclusive property of FX SIGNS INC. and is protected by federal copyrights laws. Any reproduction or construction of a sign similar to the one embodied herein is expressly prohibited without prior written consent of FX SIGNS INC.

A SIGN ELEVATION LAYOUT

SIGN AREA: 41.79

Quantity: One (1) Required

SCALE: 1/2" = 1'-0"

MANUFACTURE AND INSTALL REVERSE HALO LETTERS FOR (PHILZ COFFEE) & DUAL LIT CHANNEL FOR (STEAM & CUP) MOUNTED ONTO BACKER

SHOEBOX STYLE BACKER:

FACE: Shoebox Style .090 alum. welded to aluminum return painted double coated clear matte finish
BACK: Shoebox Style .090 alum. welded to aluminum return painted double coated clear matte finish
RETURN: 1" deep .063 alum. painted double coated clear matte finish
Secured w/ #8-14 thread x 3/4" zinc phillips flat head screws (1 every 10"-12" apart)

PHILZ COFFEE (REVERSE HALO CHANNEL LETTERS):

FACES: .090 aluminum painted white
BACKS: 3/16" thick clear lexan for halo effect with diffuser apply to the back & clinched to letter returns
RETURNS: 3" deep .063 alum. Pre-coat White
SPACERS: To be mounted 2" away from Shoebox Style aluminum face w/ #10-24 x 3" screws w/ 3/8"Ø spacers (4-6 spacers) & painted double coat clear matte finish
LIGHTING: **12V LEDs 3000K Maximum White Illumination** | Remote power supplies

STEAM & CUP (DUAL LIT PAN-CHANNEL):

FACES: Routed out .090 aluminum painted double coated clear matte finish
GRAPHICS: Backed up 3/16" thick white acrylic with painted graphics (See colors schedule)
BACKS: 3/16" thick clear lexan for halo effect with diffuser apply to the back & clinched to letter returns
RETURNS: 3" deep .063 aluminum painted double coated clear matte finish
SPACERS: To be mounted 2" away from Shoebox Style aluminum face w/ #10-24 x 3" screws w/ 3/8"Ø spacers (4-6 spacers) & painted double coat clear matte finish
LIGHTING: **12V LEDs 3000K Maximum White Illumination** | Remote power supplies

ALL COMPONENTS TO BE APPROVED

UL MANUFACTOR #E357488

REQUIREMENTS FOR ELECTRICAL ILLUMINATION:

PRIMARY ELECTRICAL TO SIGN LOCATIONS TO BE PROVIDED BY OTHERS WITH NO SHARED NEUTRALS AND A GROUND RETURNING TO THE PANEL IS REQUIRED FOR INSTALLATION. ALL TRANSFORMERS SHALL BE, (GFI) GROUND FAULT-INTERRUPTED TRANSFORMERS. ALL SIGNS HAVE (DEDICATED BRANCH CIRCUIT • THREE WIRES: LINE, NEUTRAL, & GROUND • WIRE SIZE: MINIMUM OF 12 GA. THIN COPPER WIRE) ALSO NOTE: GAUGE OF WIRE IS DETERMINED BY THE LENGTH OF RUN & AMPERAGE AS PER NEC ARTICLE 300. (GROUND WIRES MUST BE CONTINUOUS AND GO FROM THE SIGN TO THE PANEL BOARD GROUND BUS. • VOLTAGE SHOULD READ NO MORE THEN 3 VOLTS BETWEEN GROUND AND NEUTRAL. • CONDUIT CAN NOT BE USED A GROUND PATH.

NOTE TO ALL CONTRACTORS:

THIS SIGN IS INTENDED TO BE INSTALLED IN ACCORDANCE WITH REQUIREMENTS OF ARTICLE 600 OF THE NATIONAL ELECTRICAL CODE AND / OR OTHER APPLICABLE LOCAL CODES. THE INCLUDES PROPER GROUNDING AND BONDING OF THE SIGN. THE LOCATION OF THE DISCONNECT SWITCH AFTER INSTALLATION SHALL COMPLY WITH ARTICEAE 600.6(A)(1) OF THE NATIONAL ELECTRICAL CODE. **ONE (1) DEDICATED • 20AMP CIRCUIT AT 120V (NOTE 1: ALL ABOVE IS NOT IN SIGN COMPANY SCOPE OF WORK AND MUST BE IN PLACE PRIOR TO INSTALLATION. CIRCUIT TO BE BROUGHT TO JOB SITE BY LICENSED ELECTRICIAN.) (NOTE 2: TIMERS AND/OR PHOTOCELLS FOR SIGNS TO BE FURNISHED AND INSTALLED BY THE CUSTOMER'S ELECTRICAN, WHO SHOULD ALSO ENSURE THAT THE COMPLETED ELECTRICAL SYSTEM IS CODE COMPLIANT.**

- REVERSE HALO FOR (PHILZ COFFEE)
- .090 ALUMINUM FACES
- 3/16" THICK CLEAR LEXAN BACKS
- 3" DEEP .063 ALUMINUM RETURNS
- 1" DEEP SHOEBOX STYLE BACKER
- 3/8"Ø X 2" ROUND TUBE SPACERS
- REMOTE POWER SUPPLY

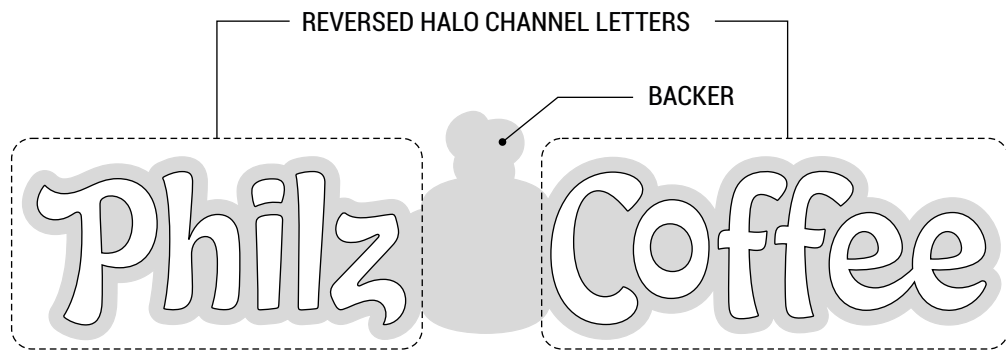

3 REVERSED HALO CHANNEL LETTERS MOUNTED 2" AWAY FROM BACKER

NOT TO SCALE

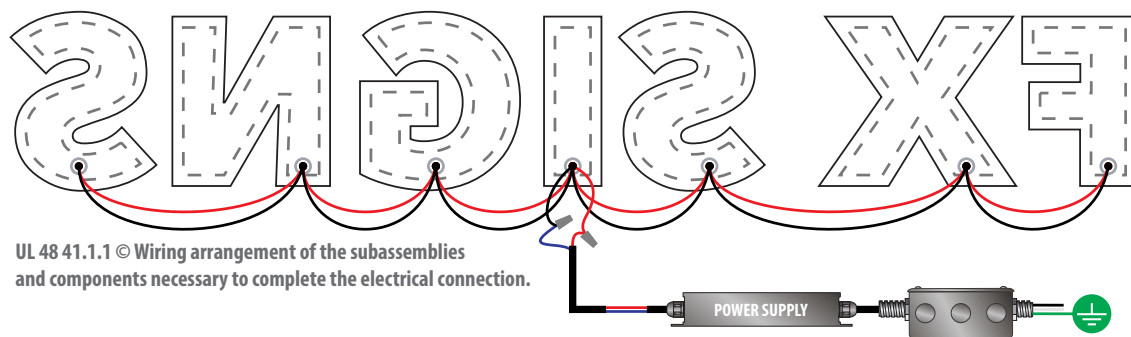

2 WIRING GUIDELINE

NOT TO SCALE

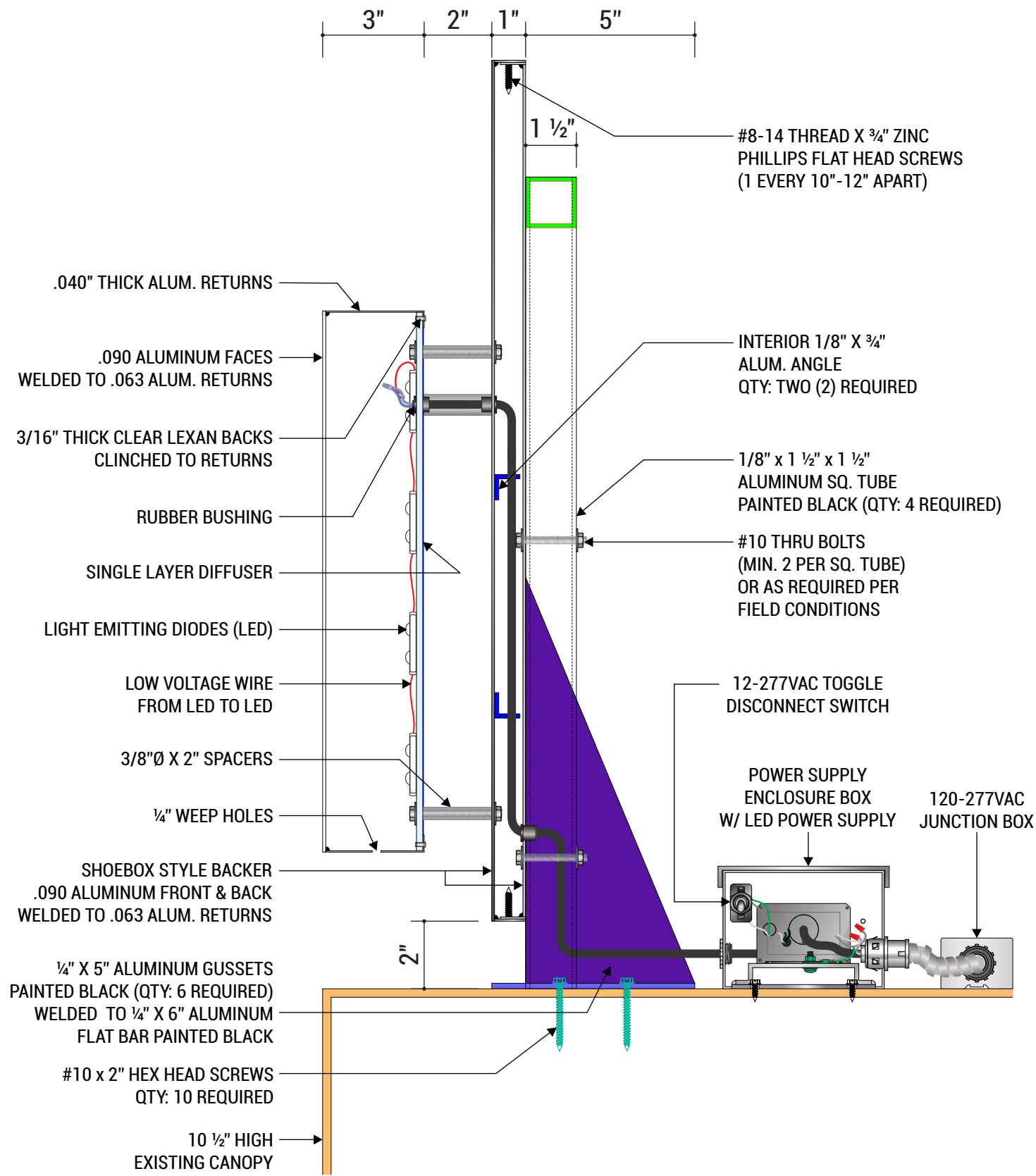

1 REVERSE HALO CHANNEL LETTERS MOUNTED TO BACKER W/ SPACERS

SCALE: NTS



CREATING VISUAL IMPACT

12155 MAGNOLIA AVE BLDG 11-A
RIVERSIDE, CA 92503
(951) 689-0270
FXCVI.COM
LIC# 1014540

SITE LOCATION:

PHILZ COFFEE

202 N Glassell St
Orange, CA 92886

CLIENT:

PHILZ COFFEE
Email: info@philzcoffee.com

Rob George
Email: robgeorge@philzcoffee.com
Phone: (408) 838-6451

PROPERTY OWNER / MGT

CREATED DATE:

May 30, 2025

JOB NUMBER:

1895 R11 | 250006 City R01

SALES REP:
FL

DRAWN BY:
SP

REVISION: R11
02 23 2026

REVISED BY: SP

CLIENT APPROVAL:

DATE:

LANDLORD APPROVAL:

DATE:

Approved For Construction

ACCOUNT MANAGER:

DATE:

DESIGNER:

DATE:

PRODUCTION:

DATE:

SHEET: 7 OF 11

ALL COMPONENTS TO BE APPROVED

REQUIREMENTS FOR ELECTRICAL ILLUMINATION:

PRIMARY ELECTRICAL TO SIGN LOCATIONS TO BE PROVIDED BY OTHERS WITH NO SHARED NEUTRALS AND A GROUND RETURNING TO THE PANEL IS REQUIRED FOR INSTALLATION. ALL TRANSFORMERS SHALL BE, (GFI) GROUND FAULT-INTERRUPTED TRANSFORMERS. ALL SIGNS HAVE (DEDICATED BRANCH CIRCUIT • THREE WIRES: LINE, NEUTRAL, & GROUND • WIRE SIZE: MINIMUM OF 12 GA. THIN COPPER WIRE) ALSO NOTE: GAUGE OF WIRE IS DETERMINED BY THE LENGTH OF RUN & AMPERAGE AS PER NEC ARTICLE 300. (GROUND WIRES MUST BE CONTINUOUS AND GO FROM THE SIGN TO THE PANEL BOARD GROUND BUS. • VOLTAGE SHOULD READ NO MORE THEN 3 VOLTS BETWEEN GROUND AND NEUTRAL. • CONDUIT CAN NOT BE USED A GROUND PATH.

UL MANUFACTOR #E357488

NOTE TO ALL CONTRACTORS:

THIS SIGN IS INTENDED TO BE INSTALLED IN ACCORDANCE WITH REQUIREMENTS OF ARTICLE 600 OF THE NATIONAL ELECTRICAL CODE AND / OR OTHER APPLICABLE LOCAL CODES. THE INCLUDES PROPER GROUNDING AND BONDING OF THE SIGN. THE LOCATION OF THE DISCONNECT SWITCH AFTER INSTALLATION SHALL COMPLY WITH ARTICEAE 600.6(A)(1) OF THE NATIONAL ELECTRICAL CODE. ONE (1) DEDICATED • 20AMP CIRCUIT AT 120V (NOTE 1: ALL ABOVE IS NOT IN SIGN COMPANY SCOPE OF WORK AND MUST BE IN PLACE PRIOR TO INSTALLATION. CIRCUIT TO BE BROUGHT TO JOB SITE BY LICENSED ELECTRICIAN.) (NOTE 2: TIMERS AND/OR PHOTOCELLS FOR SIGNS TO BE FURNISHED AND INSTALLED BY THE CUSTOMER'S ELECTRICIAN, WHO SHOULD ALSO ENSURE THAT THE COMPLETED ELECTRICAL SYSTEM IS CODE COMPLIANT.

© 2024 - This original design(s) is the exclusive property of FX SIGNS INC. and is protected by federal copyrights laws. Any reproduction or construction of a sign similar to the one embodied herein is expressly prohibited without prior written consent of FX SIGNS INC.

- DUAL LIT PAN-CHANNEL FOR (STEAM & CUP)
- 3/16" THICK ACRYLIC FACE
- 3/16" THICK CLEAR LEXAN BACK
- 3" DEEP .063 ALUMINUM RETURNS
- 1" DEEP SHOEBOX STYLE BACKER
- 3/8"Ø X 2" ROUND TUBE SPACERS
- REMOTE POWER SUPPLY

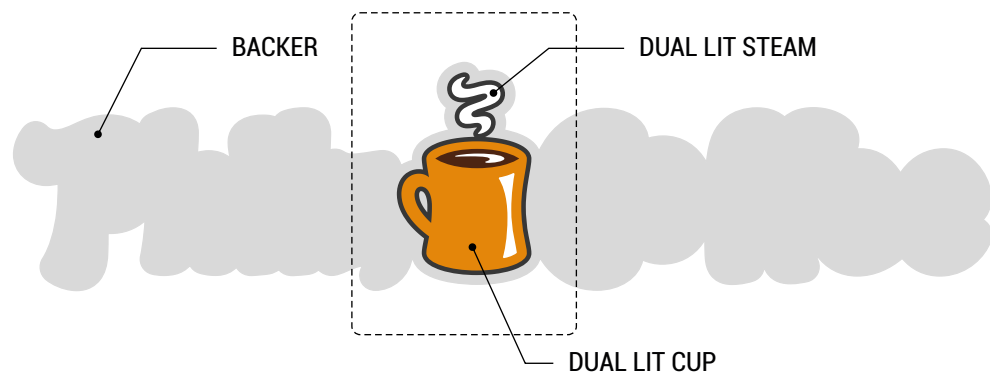

3 DUAL LIT PAN-CHANNEL FOR "STEAM & CUP" MOUNTED 2" AWAY FROM BACKER

NOT TO SCALE

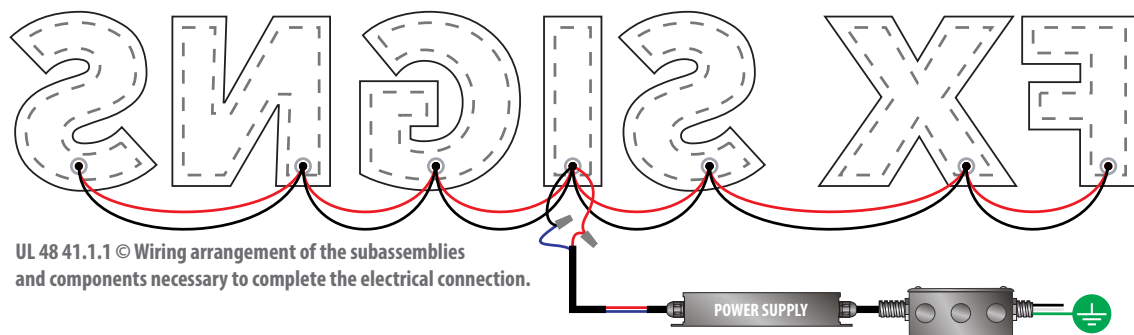

UL 48 41.1.1 © Wiring arrangement of the subassemblies and components necessary to complete the electrical connection.

2 WIRING GUIDELINE

NOT TO SCALE

ALL COMPONENTS TO BE APPROVED

REQUIREMENTS FOR ELECTRICAL ILLUMINATION:

PRIMARY ELECTRICAL TO SIGN LOCATIONS TO BE PROVIDED BY OTHERS WITH NO SHARED NEUTRALS AND A GROUND RETURNING TO THE PANEL IS REQUIRED FOR INSTALLATION. ALL TRANSFORMERS SHALL BE (GFI) GROUND FAULT-INTERRUPTED TRANSFORMERS. ALL SIGNS HAVE (DEDICATED BRANCH CIRCUIT • THREE WIRES: LINE, NEUTRAL, & GROUND • WIRE SIZE: MINIMUM OF 12 GA. THIN COPPER WIRE) ALSO NOTE: GAUGE OF WIRE IS DETERMINED BY THE LENGTH OF RUN & AMPERAGE AS PER NEC ARTICLE 300. (GROUND WIRES MUST BE CONTINUOUS AND GO FROM THE SIGN TO THE PANEL BOARD GROUND BUS. • VOLTAGE SHOULD READ NO MORE THEN 3 VOLTS BETWEEN GROUND AND NEUTRAL. • CONDUIT CAN NOT BE USED A GROUND PATH.

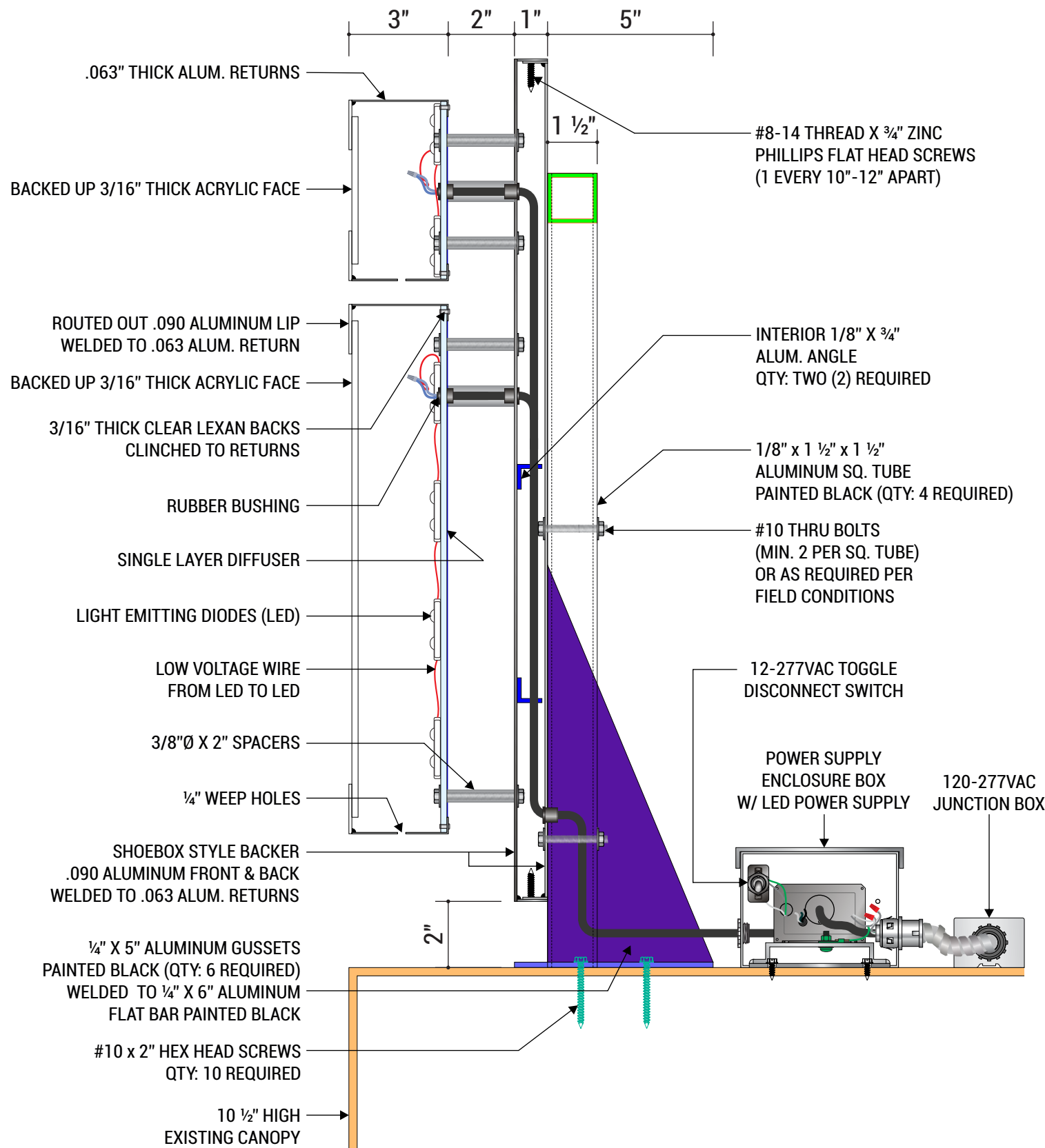

1 DUAL LIT CHANNEL LETTERS MOUNTED TO BACKER W/ SPACERS

SCALE: NTS

UL MANUFACTOR #E357488

NOTE TO ALL CONTRACTORS:

THIS SIGN IS INTENDED TO BE INSTALLED IN ACCORDANCE WITH REQUIREMENTS OF ARTICLE 600 OF THE NATIONAL ELECTRICAL CODE AND / OR OTHER APPLICABLE LOCAL CODES. THE INCLUDES PROPER GROUNDING AND BONDING OF THE SIGN. THE LOCATION OF THE DISCONNECT SWITCH AFTER INSTALLATION SHALL COMPLY WITH ARTICAE 600.6(A)(1) OF THE NATIONAL ELECTRICAL CODE. ONE (1) DEDICATED • 20AMP CIRCUIT AT 120V (NOTE 1: ALL ABOVE IS NOT IN SIGN COMPANY SCOPE OF WORK AND MUST BE IN PLACE PRIOR TO INSTALLATION. CIRCUIT TO BE BROUGHT TO JOB SITE BY LICENSED ELECTRICIAN.) (NOTE 2: TIMERS AND/OR PHOTOCELLS FOR SIGNS TO BE FURNISHED AND INSTALLED BY THE CUSTOMER'S ELECTRICIAN, WHO SHOULD ALSO ENSURE THAT THE COMPLETED ELECTRICAL SYSTEM IS CODE COMPLIANT.



CREATING VISUAL IMPACT

12155 MAGNOLIA AVE BLDG 11-A
RIVERSIDE, CA 92503
(951) 689-0270
FXCVI.COM
LIC# 1014540

SITE LOCATION:

PHILZ COFFEE

202 N Glassell St
Orange, CA 92886

CLIENT:

PHILZ COFFEE
Email: info@philzcoffee.com

Rob George
Email: robgeorge@philzcoffee.com
Phone: (408) 838-6451

PROPERTY OWNER / MGT

CREATED DATE:

May 30, 2025

JOB NUMBER:

1895 R11 | 250006 City R01

SALES REP:

FL

DRAWN BY:

SP

REVISION: R11
02 23 2026

REVISED BY: SP

CLIENT APPROVAL:

DATE:

LANDLORD APPROVAL:

DATE:

Approved For Construction

ACCOUNT MANAGER:

DATE:

DESIGNER:

DATE:

PRODUCTION:

DATE:

SHEET:

8 OF 11

© 2024 - This original design(s) is the exclusive property of FX SIGNS INC. and is protected by federal copyrights laws. Any reproduction or construction of a sign similar to the one embodied herein is expressly prohibited without prior written consent of FX SIGNS INC.



EXISTING CABINET

STEAM & CUP.
 • ROUTED OUT ALUMINUM FACE
 • DUAL LIT PAN-CHANNEL
 • BACKED UP WHITE ACRYLIC

ALUMINUM BACKER

PHILZ COFFEE:
 • REVERSED HALO CHANNEL LETTERS

2" SPACERS



1 3D RENDERING ISO VIEW

NOT TO SCALE

2 3D RENDERING SIDE VIEW

NOT TO SCALE



CREATING VISUAL IMPACT

12155 MAGNOLIA AVE BLDG 11-A
 RIVERSIDE, CA 92503
 (951) 689-0270
 FXCVI.COM
 LIC# 1014540

SITE LOCATION:

PHILZ COFFEE

202 N Glassell St
 Orange, CA 92886

CLIENT:

PHILZ COFFEE
 Email: info@philzcoffee.com

Rob George
 Email: robgeorge@philzcoffee.com
 Phone: (408) 838-6451

PROPERTY OWNER / MGT

CREATED DATE:

May 30, 2025

JOB NUMBER:

1895 R11 | 250006 City R01

SALES REP:
 FL

DRAWN BY:
 SP

REVISION: R11
02 23 2026

REVISED BY: SP

CLIENT APPROVAL:

DATE:

LANDLORD APPROVAL:

DATE:

Approved For Construction

ACCOUNT MANAGER:

DATE:

DESIGNER:

DATE:

PRODUCTION:

DATE:

SHEET: **9** OF **11**

© 2024 - This original design(s) is the exclusive property of FX SIGNS INC. and is protected by federal copyrights laws. Any reproduction or construction of a sign similar to the one embodied herein is expressly prohibited without prior written consent of FX SIGNS INC.

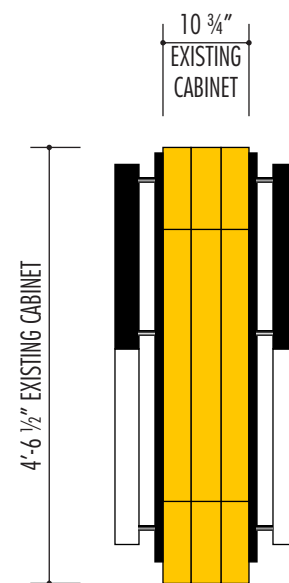
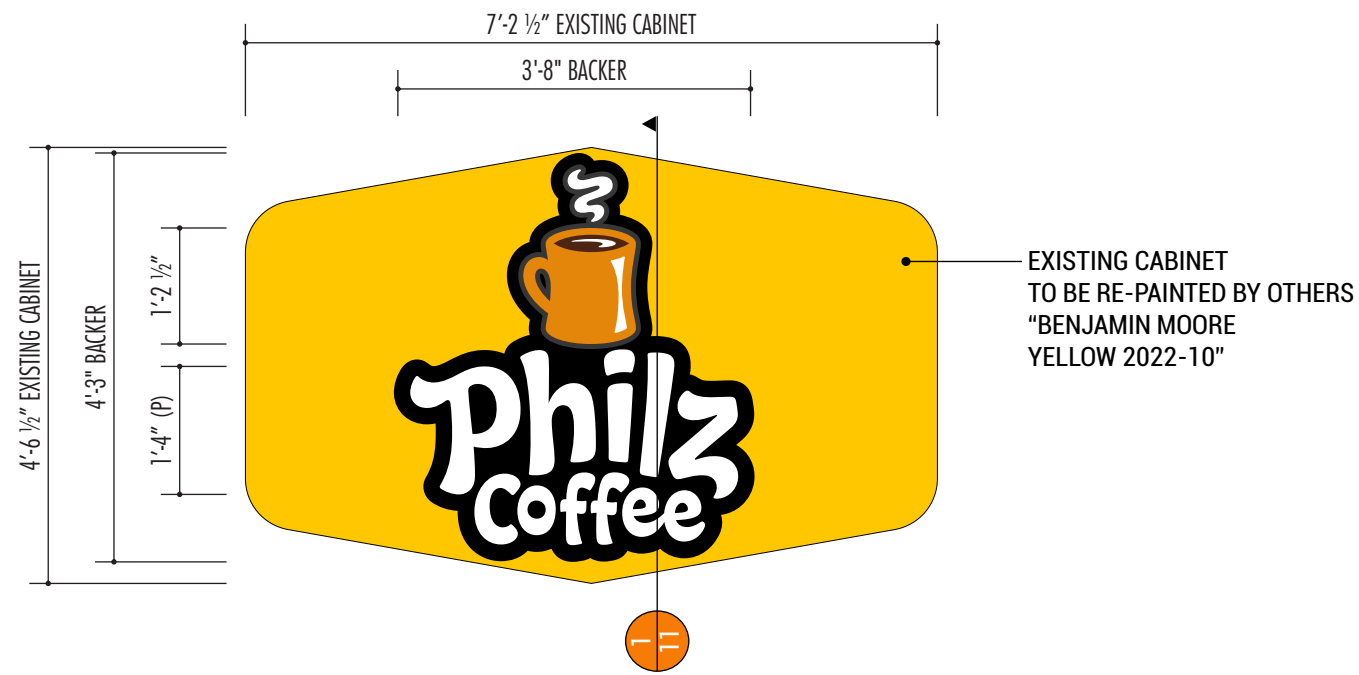

MATERIALS SCHEDULE

- M1 3/16" Thick White Acrylic
- M2 3/16" Clear Lexan Backs
- M3 1" Trimcaps Pre-coat White
- M4 .040 Aluminum
- M5 .063 Aluminum
- M6 .090 Aluminum

PAINT SCHEDULE

- P1 Clear Matte Finish
- P2 3M 3630-59 Dark Brown
- P3 3M 3630-84 Tangerine



CREATING VISUAL IMPACT

12155 MAGNOLIA AVE BLDG 11-A
RIVERSIDE, CA 92503
(951) 689-0270
FXCVI.COM
LIC# 1014540

SITE LOCATION:

PHILZ COFFEE

202 N Glassell St
Orange, CA 92886

CLIENT:

PHILZ COFFEE
Email: info@philzcoffee.com

Rob George
Email: robgeorge@philzcoffee.com
Phone: (408) 838-6451

PROPERTY OWNER / MGT

CREATED DATE:

May 30, 2025

JOB NUMBER:

1895 R11 | 250006 City R01

SALES REP:

FL

DRAWN BY:

SP

REVISION: R11
02 23 2026

REVISED BY: SP

CLIENT APPROVAL:

DATE:

LANDLORD APPROVAL:

DATE:

Approved For Construction

ACCOUNT MANAGER:

DATE:

DESIGNER:

DATE:

PRODUCTION:

DATE:

SHEET: **10** OF **11**

© 2024 - This original design(s) is the exclusive property of FX SIGNS INC. and is protected by federal copyrights laws. Any reproduction or construction of a sign similar to the one embodied herein is expressly prohibited without prior written consent of FX SIGNS INC.

B SIGN ELEVATION LAYOUT

Quantity: One (1) Required

SIGN AREA: 15.93

SCALE: 1/2" = 1'-0"

MANUFACTURE AND INSTALL REVERSE HALO LETTERS FOR (PHILZ COFFEE) & DUAL LIT CHANNEL FOR (STEAM & CUP) MOUNTED ONTO BACKER

SHOEBOX STYLE BACKER:

- FACE: Shoebox Style .090 alum. welded to aluminum return painted double coated clear matte finish
- BACK: Shoebox Style .090 alum. welded to aluminum return painted double coated clear matte finish
- RETURN: 1" deep .063 alum. painted double coated clear matte finish
Secured w/ #8-14 thread x 3/4" zinc phillips flat head screws (1 every 10"-12" apart)

PHILZ COFFEE (REVERSE HALO CHANNEL LETTERS):

- FACES: .090 aluminum painted white
- BACKS: 3/16" thick clear lexan for halo effect with diffuser apply to the back & clinched to letter returns
- RETURNS: 3" deep .063 alum. Pre-coat White
- SPACERS: To be mounted 2" away from Shoebox Style aluminum face w/ #10-24 x 3" screws w/ 3/8"Ø spacers (4-6 spacers) & painted double coat clear matte finish
- LIGHTING: **12V LEDs 3000K Maximum White Illumination** | Remote power supplies

STEAM & CUP (DUAL LIT PAN-CHANNEL):

- FACES: Routed out .090 aluminum painted double coated clear matte finish
- GRAPHICS: Backed up 3/16" thick white acrylic with painted graphics (See colors schedule)
- BACKS: 3/16" thick clear lexan for halo effect with diffuser apply to the back & clinched to letter returns
- RETURNS: 3" deep .063 aluminum painted double coated clear matte finish
- SPACERS: To be mounted 2" away from Shoebox Style aluminum face w/ #10-24 x 3" screws w/ 3/8"Ø spacers (4-6 spacers) & painted double coat clear matte finish
- LIGHTING: **12V LEDs 3000K Maximum White Illumination** | Remote power supplies

1 OPPOSITE VIEW

SCALE: 1/2" = 1'-0"



2 OPPOSITE VIEW

SCALE: 1/2" = 1'-0"

ALL COMPONENTS TO BE APPROVED

UL MANUFACTOR #E357488

REQUIREMENTS FOR ELECTRICAL ILLUMINATION:

PRIMARY ELECTRICAL TO SIGN LOCATIONS TO BE PROVIDED BY OTHERS WITH NO SHARED NEUTRALS AND A GROUND RETURNING TO THE PANEL IS REQUIRED FOR INSTALLATION. ALL TRANSFORMERS SHALL BE, (GFI) GROUND FAULT-INTERRUPTED TRANSFORMERS. ALL SIGNS HAVE (DEDICATED BRANCH CIRCUIT • THREE WIRES: LINE, NEUTRAL, & GROUND • WIRE SIZE: MINIMUM OF 12 GA. THIN COPPER WIRE) ALSO NOTE: GAUGE OF WIRE IS DETERMINED BY THE LENGTH OF RUN & AMPERAGE AS PER NEC ARTICLE 300. (GROUND WIRES MUST BE CONTINUOUS AND GO FROM THE SIGN TO THE PANEL BOARD GROUND BUS. • VOLTAGE SHOULD READ NO MORE THEN 3 VOLTS BETWEEN GROUND AND NEUTRAL. • CONDUIT CAN NOT BE USED A GROUND PATH.

NOTE TO ALL CONTRACTORS:

THIS SIGN IS INTENDED TO BE INSTALLED IN ACCORDANCE WITH REQUIREMENTS OF ARTICLE 600 OF THE NATIONAL ELECTRICAL CODE AND / OR OTHER APPLICABLE LOCAL CODES. THE INCLUDES PROPER GROUNDING AND BONDING OF THE SIGN. THE LOCATION OF THE DISCONNECT SWITCH AFTER INSTALLATION SHALL COMPLY WITH ARTICEAE 600.6(A)(1) OF THE NATIONAL ELECTRICAL CODE. **ONE (1) DEDICATED • 20AMP CIRCUIT AT 120V (NOTE 1: ALL ABOVE IS NOT IN SIGN COMPANY SCOPE OF WORK AND MUST BE IN PLACE PRIOR TO INSTALLATION. CIRCUIT TO BE BROUGHT TO JOB SITE BY LICENSED ELECTRICIAN.) (NOTE 2: TIMERS AND/OR PHOTOCELLS FOR SIGNS TO BE FURNISHED AND INSTALLED BY THE CUSTOMER'S ELECTRICAN, WHO SHOULD ALSO ENSURE THAT THE COMPLETED ELECTRICAL SYSTEM IS CODE COMPLIANT.**

STEAM & CUP

- DUAL LIT PAN-CHANNEL
- 3/16" THICK ACRYLIC FACE
- 3/16" THICK CLEAR LEXAN BACK
- 3" DEEP .063 ALUMINUM RETURNS
- 1" DEEP SHOEBOX STYLE BACKER
- 3/8"Ø X 2" ROUND TUBE SPACERS
- POWER SUPPLY INSIDE CABINET

PHILZ COFFEE

- REVERSE HALO
- .090 ALUMINUM FACES
- 3/16" THICK CLEAR LEXAN BACKS
- 3" DEEP .063 ALUMINUM RETURNS
- 1" DEEP SHOEBOX STYLE BACKER
- 3/8"Ø X 2" ROUND TUBE SPACERS

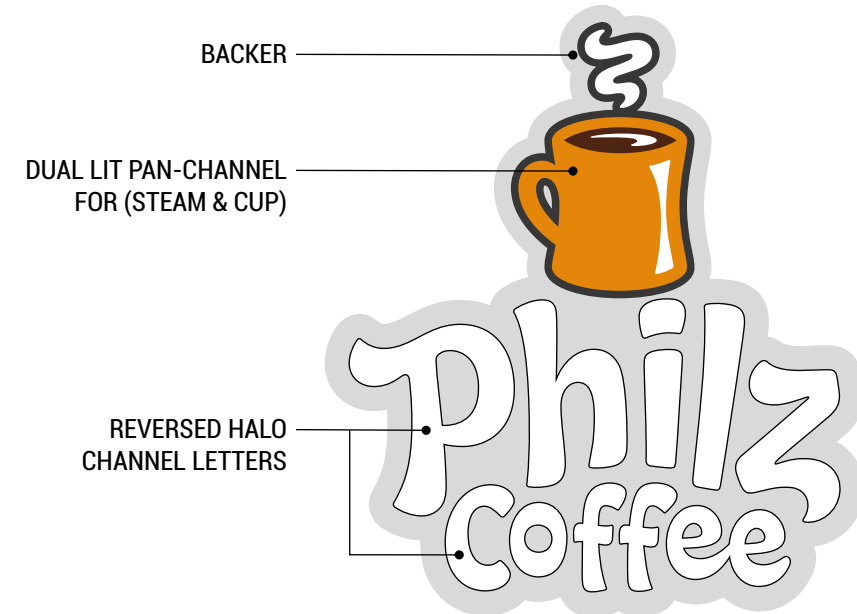

REVERSED HALO CHANNEL LETTERS MOUNTED

3 2" AWAY FROM BACKER

NOT TO SCALE

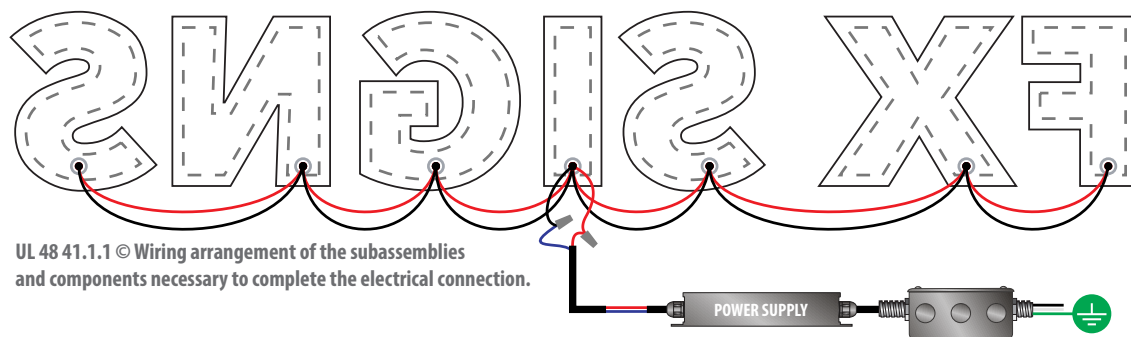

UL 48 41.1.1 © Wiring arrangement of the subassemblies and components necessary to complete the electrical connection.

2 WIRING GUIDELINE

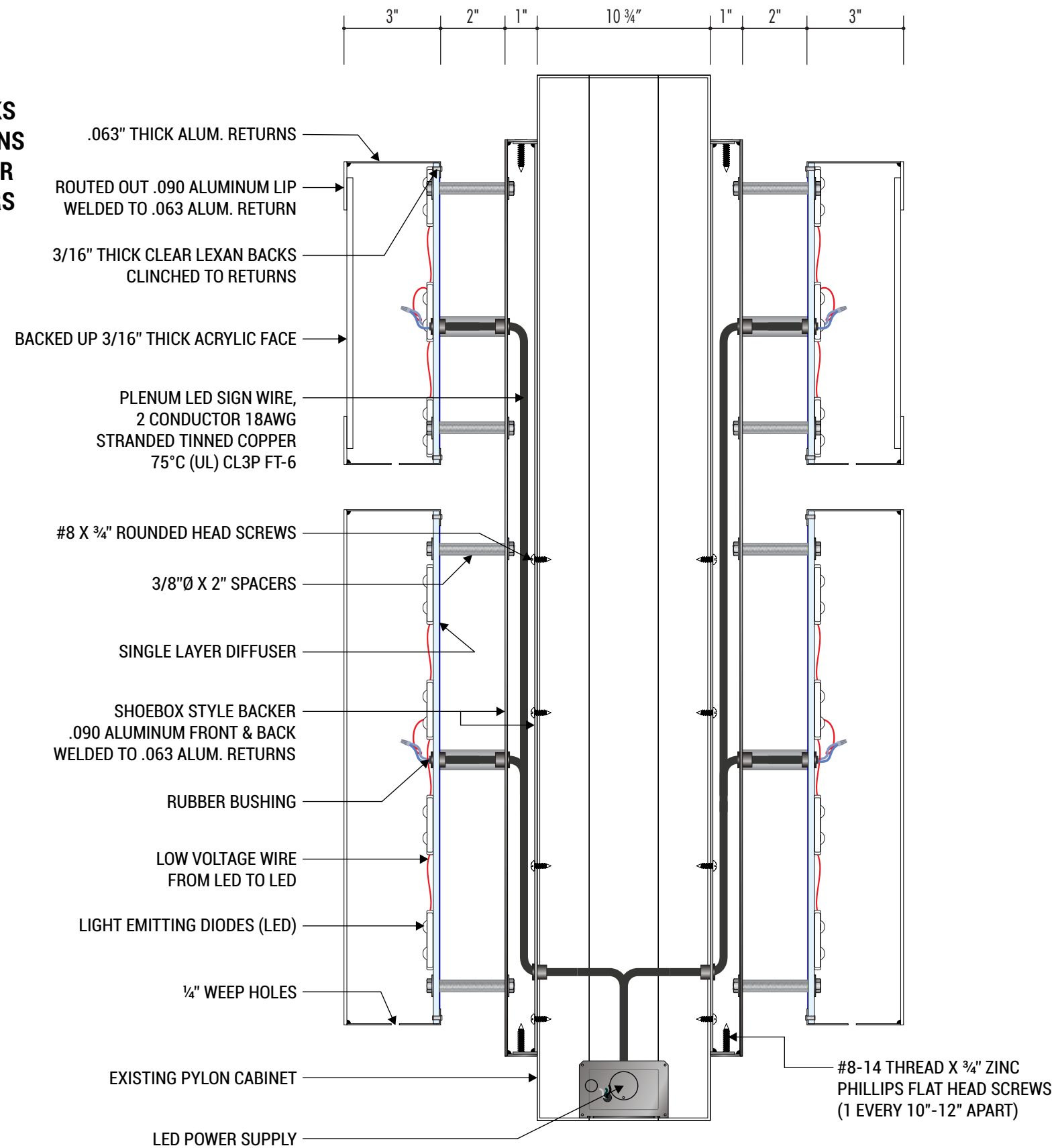

1 REVERSE HALO CHANNEL LETTERS MOUNTED TO BACKER W/ SPACERS

SCALE: NTS



CREATING VISUAL IMPACT

12155 MAGNOLIA AVE BLDG 11-A
RIVERSIDE, CA 92503
(951) 689-0270
FXCVI.COM
LIC# 1014540

SITE LOCATION:

PHILZ COFFEE

202 N Glassell St
Orange, CA 92886

CLIENT:

PHILZ COFFEE
Email: info@philzcoffee.com

Rob George
Email: robgeorge@philzcoffee.com
Phone: (408) 838-6451

PROPERTY OWNER / MGT

CREATED DATE:

May 30, 2025

JOB NUMBER:

1895 R11 | 250006 City R01

SALES REP: FL

DRAWN BY: SP

REVISION: R11
02 23 2026

REVISED BY: SP

CLIENT APPROVAL: DATE:

LANDLORD APPROVAL: DATE:

Approved For Construction

ACCOUNT MANAGER: DATE:

DESIGNER: DATE:

PRODUCTION: DATE:

SHEET: **11** OF **11**

© 2024 - This original design(s) is the exclusive property of FX SIGNS INC. and is protected by federal copyrights laws. Any reproduction or construction of a sign similar to the one embodied herein is expressly prohibited without prior written consent of FX SIGNS INC.

ALL COMPONENTS TO BE APPROVED

REQUIREMENTS FOR ELECTRICAL ILLUMINATION:

PRIMARY ELECTRICAL TO SIGN LOCATIONS TO BE PROVIDED BY OTHERS WITH NO SHARED NEUTRALS AND A GROUND RETURNING TO THE PANEL IS REQUIRED FOR INSTALLATION. ALL TRANSFORMERS SHALL BE, (GFI) GROUND FAULT-INTERRUPTED TRANSFORMERS. ALL SIGNS HAVE (DEDICATED BRANCH CIRCUIT • THREE WIRES: LINE, NEUTRAL, & GROUND • WIRE SIZE: MINIMUM OF 12 GA. THIN COPPER WIRE) ALSO NOTE: GAUGE OF WIRE IS DETERMINED BY THE LENGTH OF RUN & AMPERAGE AS PER NEC ARTICLE 300. (GROUND WIRES MUST BE CONTINUOUS AND GO FROM THE SIGN TO THE PANEL BOARD GROUND BUS. • VOLTAGE SHOULD READ NO MORE THEN 3 VOLTS BETWEEN GROUND AND NEUTRAL. • CONDUIT CAN NOT BE USED A GROUND PATH.

UL MANUFACTOR #E357488

NOTE TO ALL CONTRACTORS:

THIS SIGN IS INTENDED TO BE INSTALLED IN ACCORDANCE WITH REQUIREMENTS OF ARTICLE 600 OF THE NATIONAL ELECTRICAL CODE AND / OR OTHER APPLICABLE LOCAL CODES. THE INCLUDES PROPER GROUNDING AND BONDING OF THE SIGN. THE LOCATION OF THE DISCONNECT SWITCH AFTER INSTALLATION SHALL COMPLY WITH ARTICAE 600.6(A)(1) OF THE NATIONAL ELECTRICAL CODE. **ONE (1) DEDICATED • 20AMP CIRCUIT AT 120V** (NOTE 1: ALL ABOVE IS NOT IN SIGN COMPANY SCOPE OF WORK AND MUST BE IN PLACE PRIOR TO INSTALLATION. CIRCUIT TO BE BROUGHT TO JOB SITE BY LICENSED ELECTRICIAN.) (NOTE 2: TIMERS AND/OR PHOTOCELLS FOR SIGNS TO BE FURNISHED AND INSTALLED BY THE CUSTOMER'S ELECTRICAN, WHO SHOULD ALSO ENSURE THAT THE COMPLETED ELECTRICAL SYSTEM IS CODE COMPLIANT.